

Z-Articulating Cap Sill™ Door Bottom Gasket Replacement Instructions

Required Tools and Materials

- 1. Stiff Scraper:** To remove old Door Bottom Gasket.
- 2. Saw/Cutting Tool:** To notch Door Bottom Kerf Legs.

Required Components

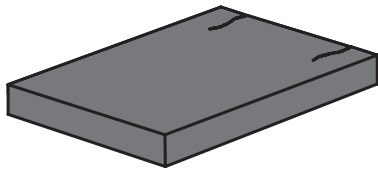

(1) Z-AC Door Bottom Gasket

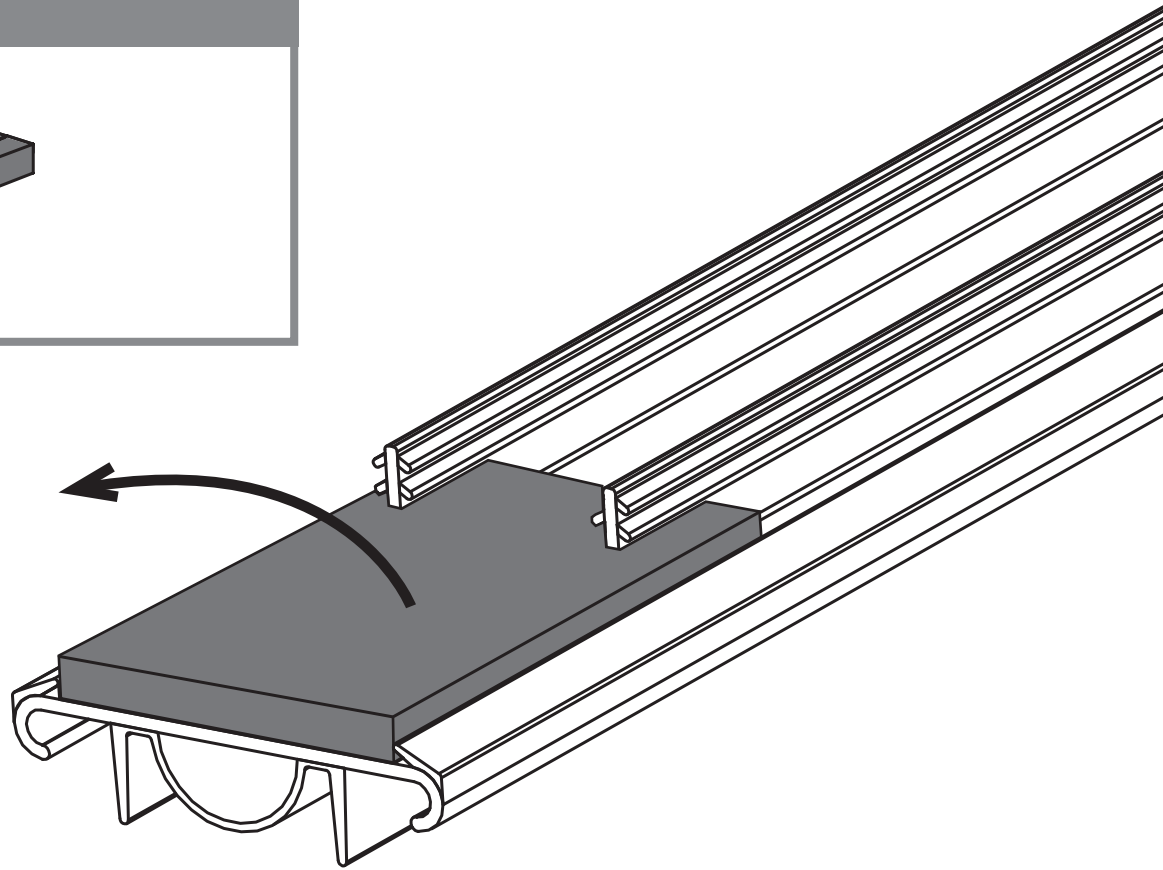

Item #: 211158-DBGASKET

The information contained in this document is the confidential and proprietary information and trade secrets of Endura Products, Inc. Any disclosure, use or dissemination of such information without the express written permission of Endura Products, Inc. is strictly prohibited. Endura Products, Inc. also owns any and all intellectual property rights embodied in such information, including patent rights, copyrights, and trademark rights, and no license of any intellectual property right is intended, nor should any license be implied, as a result of the receipt of this document.

US Patents Pending.

Canadian Patents Pending. Rev 3/10/25



8817 W. Market St., Colfax, NC 27235
1.800.334.2006 www.enduraproducts.com

Z-Articulating Cap Sill™ Door Bottom Gasket Replacement Instructions

The following steps should only be performed to only **ONE** end of the door bottom.

1. Using a stiff scraping tool, remove the existing Door Bottom Gasket from the end of the door bottom. If no Gasket is present or has been cut off completely, skip to step 2.

 Be sure to completely remove all residue from the old gasket to assure the new pad adheres properly.

2. Measure the location of the Kerf Legs. Kerf legs should be trimmed back 1-1/4" or more from the edge of the door bottom. If 1-1/4" or greater notch is present, proceed to step 4, If not proceed to step 3.

3. If less than a 1-1/4" notch is present, re-notch the Kerf Legs to at least 1-1/4" by clipping the Kerf Legs.

- a. Measure and mark the Kerf Legs at 1-1/4" from the edge of the Door Bottom. Cut the Kerf Legs down with a cutting tool to the base of the Door Bottom.

 **BE CAREFUL NOT TO CUT INTO THE DOOR BOTTOM.**

- b. From the edge of the Door Bottom, trim the Kerf Legs at the base back to the cut made in the previous step and remove.

4. Remove paper backing from the Door Bottom Gasket.

- Peel the protective paper layer covering the adhesive on the back of the Door Bottom Gasket off and discard.

5. Align and Apply New Door Bottom Gasket to Z-AC Door Bottom

- Align the Solid Edge of the Door Bottom Gasket with the outer edge of the Z-AC Door Bottom as shown. Once aligned, tip and press Gasket firmly into place, ensuring that the Door Bottom Kerf Legs protrude through the Gasket Relief Slits, while the Gasket Solid Edge remains aligned flush with the Door Bottom Edge.

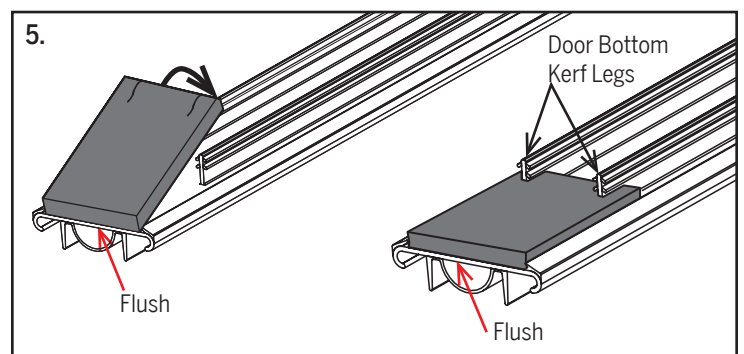
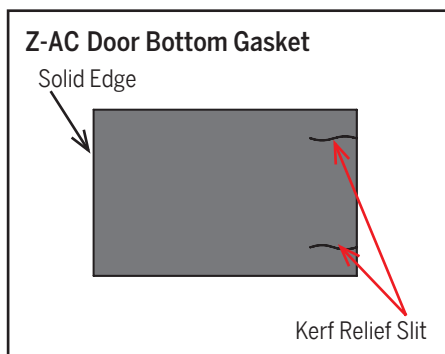
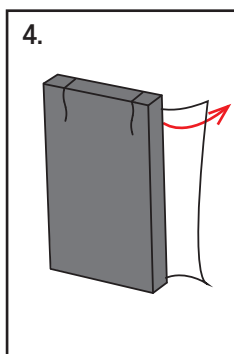
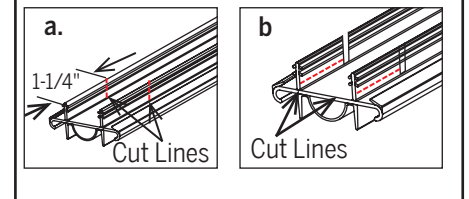
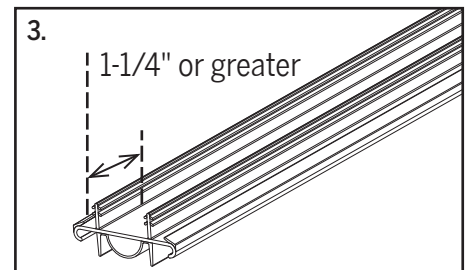
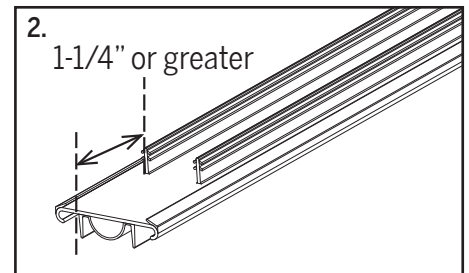
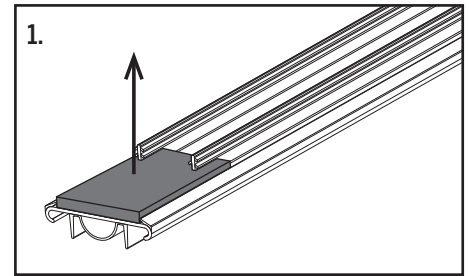

If you have any questions, please contact your Endura Sales Representative or call Customer Service: 1-800-334-2006



8817 W. Market St., Colfax, NC 27235
1.800.334.2006 www.enduraproducts.com