

PanoLock®+ Multi-Point Lock Instructions Split-Escutcheon Construction Handle Installation

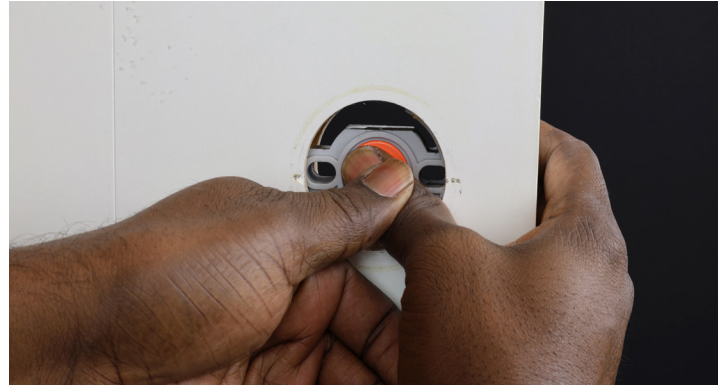

Place the orange adapter into the composite side of the handle hub and use your thumb to firmly snap into place.



Use your thumb to firmly snap into place.



Place the lever side of the handleset to the interior side of the door with the handle end aligning into the hub of Panolock+.



Align the exterior handset on the outside of the door panel. The screw bosses should be to the inside of the of the bore.



Secure the plates using the machine screws provided.



Once installed, make sure the handle operates the latch.