

TRILENNIUM®
MULTI-POINT LOCKING SYSTEMS

W&F Entry Hardware Installation Instructions For Swinging And Active French Door Lever Sets

Check contents and identify all parts before proceeding:

Interior Escutcheon:	(1) Individually packed
Exterior Escutcheon:	(1) Individually packed
Handle Pack:	(1) Escutcheon Gasket (2) Lever Handles
Key Cylinder Pack:	(1) Key Cylinder with (2) keys (2) Aluminum Drive Rods (1) #8 x 3/8" self-tapping screw (2) 10-32 Mounting screws

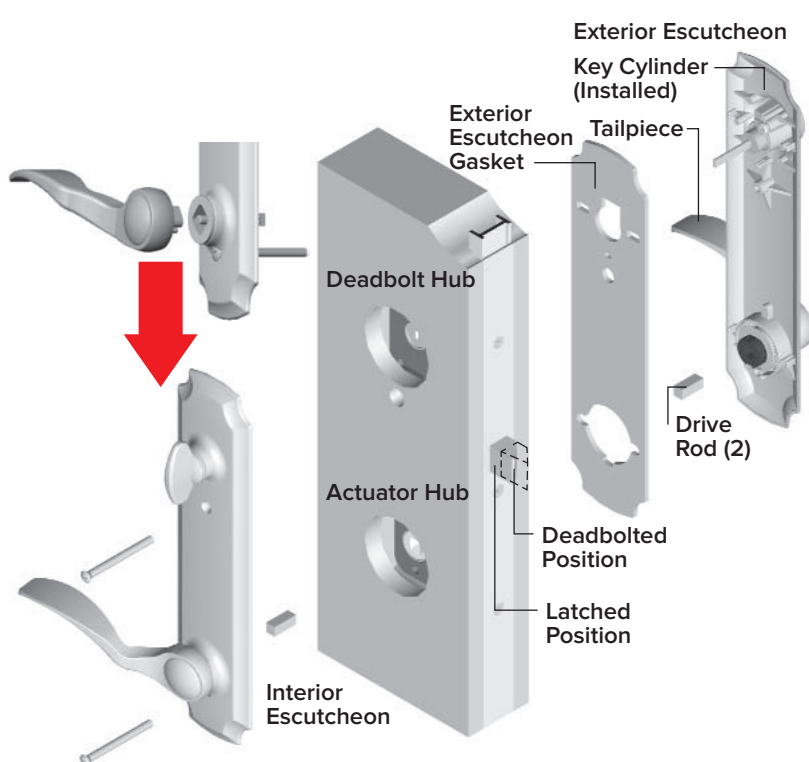

1. Attach levers to escutcheons.

- Levers are handed – one for inside, one for outside.
- Hand-tighten the pre-installed mounting screws.
- SNUG – DO NOT OVER TIGHTEN.

2. Install cylinder in outside escutcheon.

- Remove key. Insert cylinder from back side until cylinder face projects past face of escutcheon.
- Secure cylinder with #8 x 3/8 self-tapping screw.

3. Check hardware in door for alignment of hub.

- Open door by turning inside actuator hub.
- Deadbolt slot must be vertical.
- Bolts must be in latched (not deadbolted) position.

4. Position Escutcheons to door panel.

- Exterior first: Place escutcheon gasket over inside face of escutcheon. Guide cylinder tailpiece and drive rod into respective hubs in hardware.
- Hold in place.
- Next install interior escutcheon. Make certain that receiving slot in thumbturn lines up with cylinder tailpiece.
- Secure with (2) 10-32 mounting screws from interior to exterior.
- Again, hand tighten snug. DO NOT OVER TIGHTEN.

5. Attach Strikeplates to Jamb (if not already done)

- Use 3/4" screws in top and bottom holes of each strike.
- Use long #10 x 2-1/2" in center holes. The purpose of this is to anchor each strike to structural framing for additional security. A small pilot hole should be drilled for each screw.

NOTE: Solid shimming should be placed behind each strike to allow for firm anchoring to structure.

6. Check operation.

- All three bolts should engage strikes as door is closed.
- Turn thumbturn 90 degrees to extend all three bolts an additional 1/2" to deadbolted position.
- From interior, rotate lever downward to totally disengage bolts and open door. Bolts can also be un-deadbolted to latch position by turning thumbturn.
- Close deadbolt again. From the exterior, confirm that the lever won't rotate and operate the latches (door is deadbolted). Now the door can be unlocked and opened with the key.



9TSH0331 Rev. Date: 08/8/2023

© Endura Products, Inc. Innovation protected under patents and patents pending in U.S. and Canada. See www.EnduraPatents.com

8817 West Market Street, Colfax, NC 27235 | 800.334.2006
www.enduraproducts.com