

# FrameSaver® FusionFrame™

Outswing Jamb Conversion with Outswing Brickmould



## STEP 1: CUT THE JAMB TO LENGTH

### [A] FOR 2-PIECE JAMBS WITH NOTCHED + HORNED SILLS

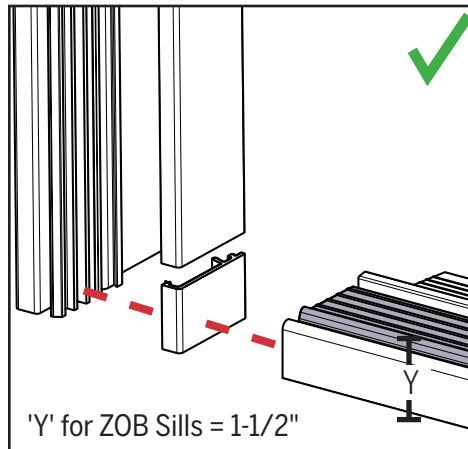
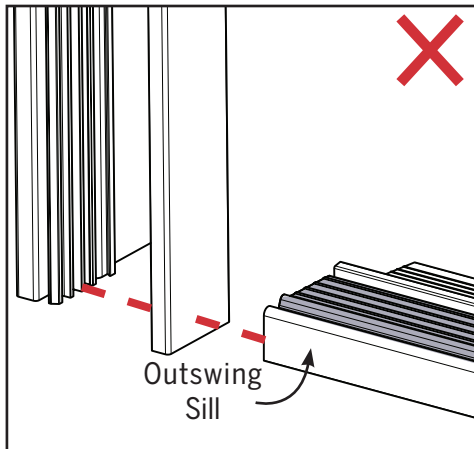

To ensure usability of the jamb stop cover in an outswing jamb application, you'll need to cut the cover into two pieces - one short fixed piece for the bottom, and another much longer piece to conceal the fasteners during installation.

As shown on the left, the cover cannot be removed without this cut as it will get caught between the sill and the jamb.

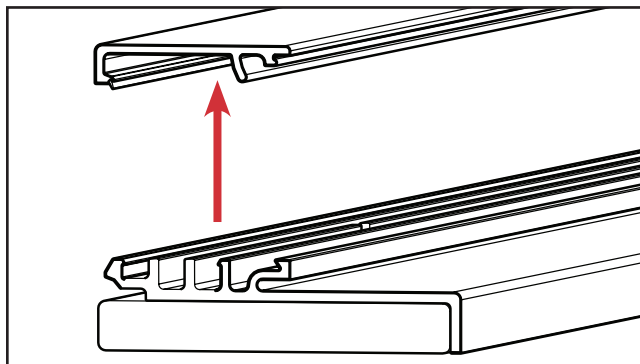

a. Remove the jamb stop cover from the jamb.

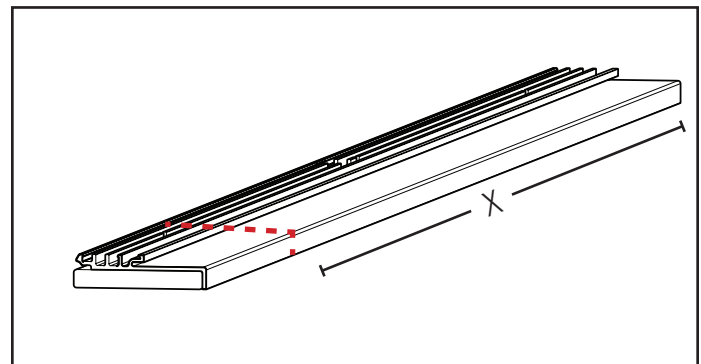

b. Measure and cut the jamb to the length needed (X). Be sure to cut from the bottom of the jamb. Note: If cutting for an inswing unit, you will need to cut 13/16" off of the bottom.

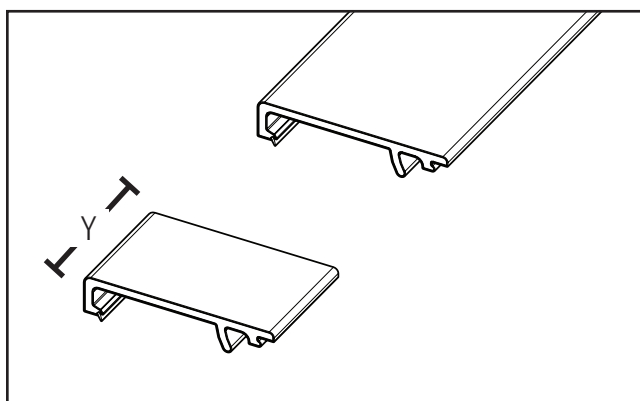

c. Measure and mark the height of the sill cap (Y) onto the bottom of the jamb stop cover. It should be around 1-3/4". Cut the jamb stop cover along the mark made.

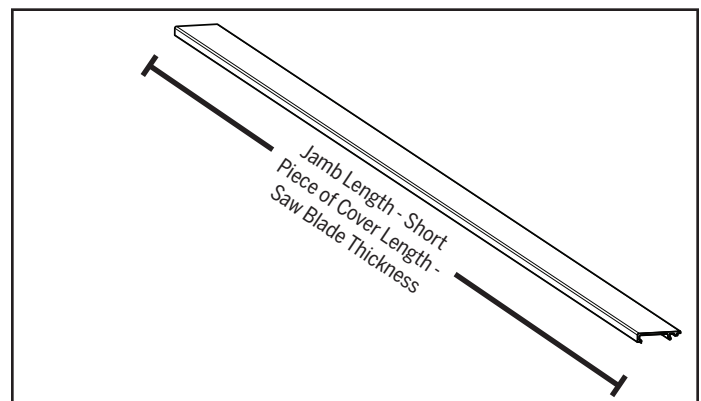

d. Measure and mark the remainder of the jamb stop cover. The measurement should leave the cover at a length equal to the Jamb Length (X) - Short Piece of Cover (Y) - Saw Blade Thickness (usually 1/8"). Cut the jamb stop cover.

## STEP 1 (CONT.): CUT THE JAMB TO LENGTH

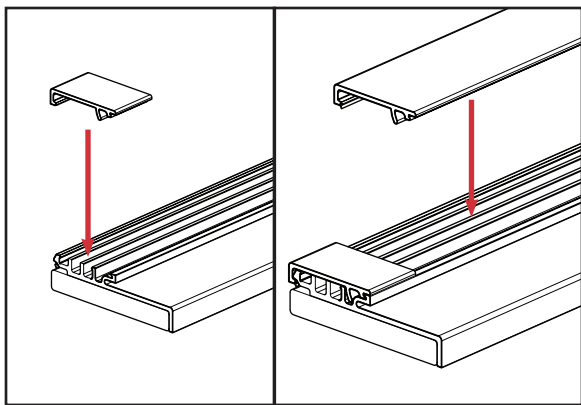

e. Reinstall the cut jamb stop covers onto the jamb.

### [B] ALL JAMBS WITH DADO

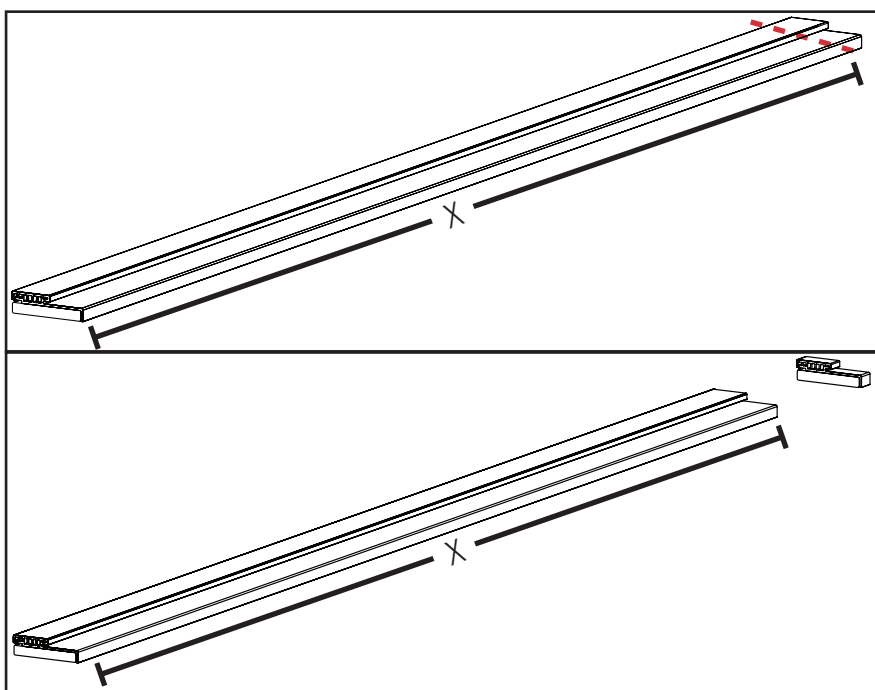

a. Measure and cut the jamb to the length needed.

## STEP 2: ATTACH OUTSWING CONNECTOR

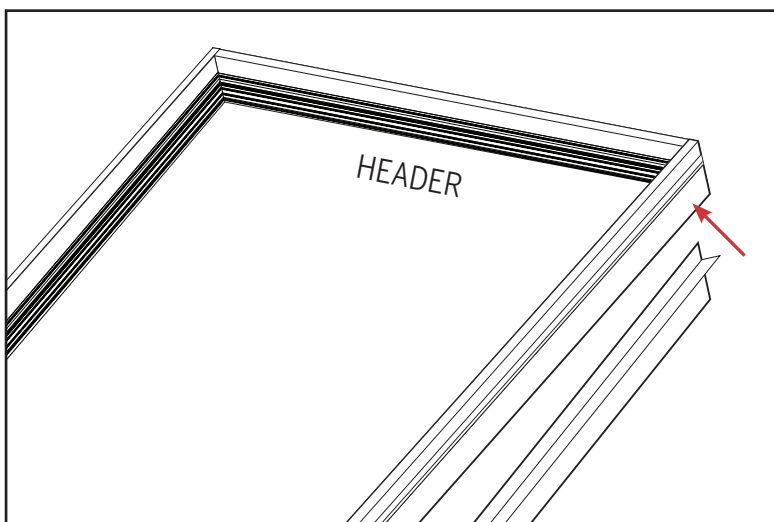

a. Assemble the jambs, header, sill, and panel.

b. Attach outswing connector to the back of the frame by pressing firmly with your hand or mallet.

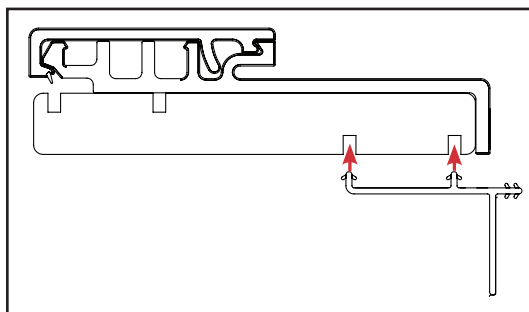

### STEP 3: INSTALL OUTSWING BRICKMOULD LEGS

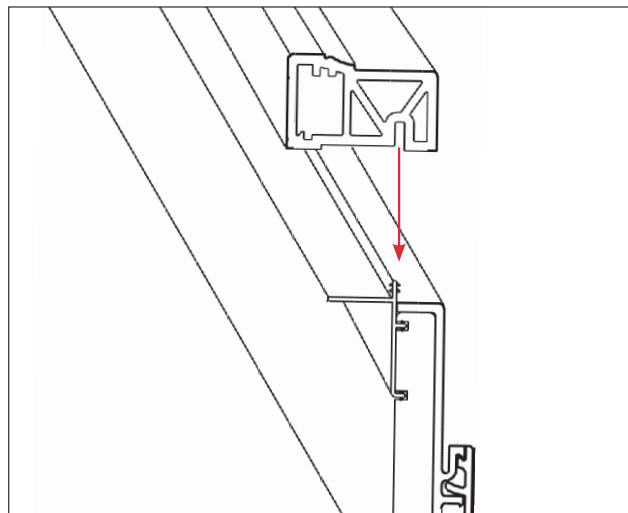
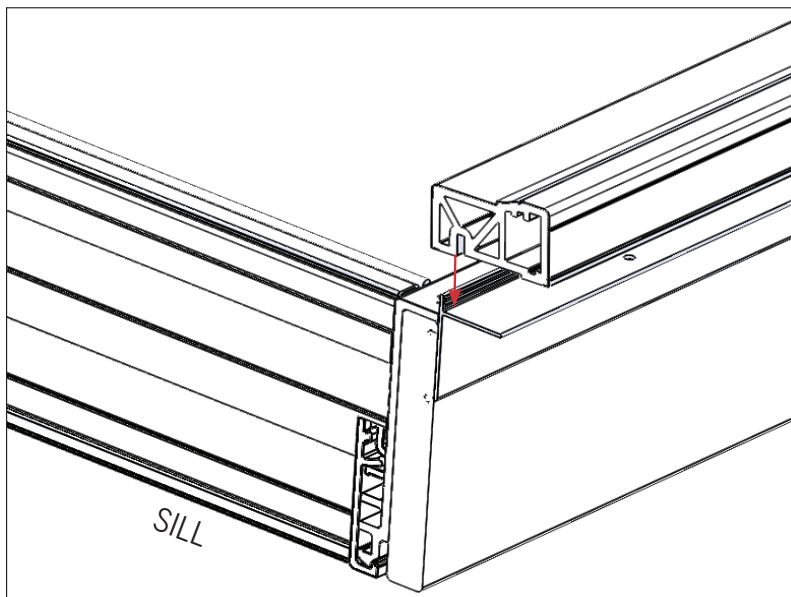

Align the outswing brickmould starting from the bottom of the unit. Attach the brickmould to the outswing connector by aligning the kerf in the brickmould with the brickmould connector fin and pressing firmly until they are securely mated. Repeat on the other side.

### STEP 4A: INSTALL OUTSWING BRICKMOULD HEADER

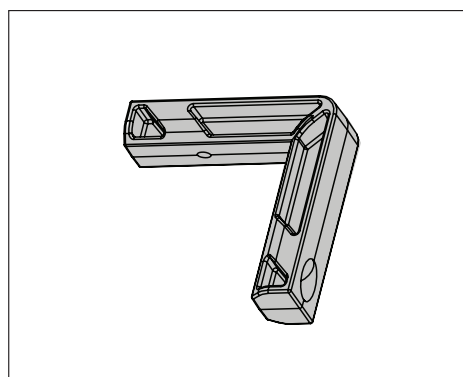
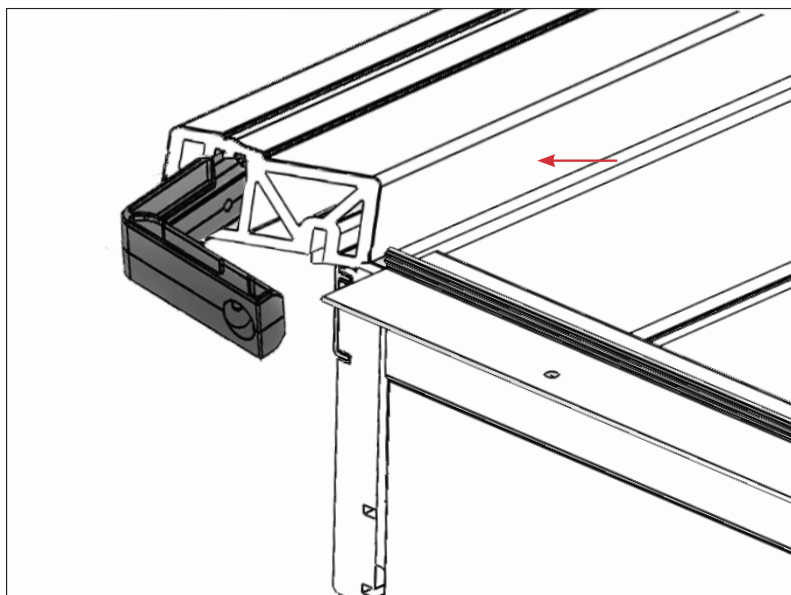

Place miter keys into both sides of outswing brickmould header.

## STEP 4B: INSTALL OUTSWING BRICKMOULD LEGS

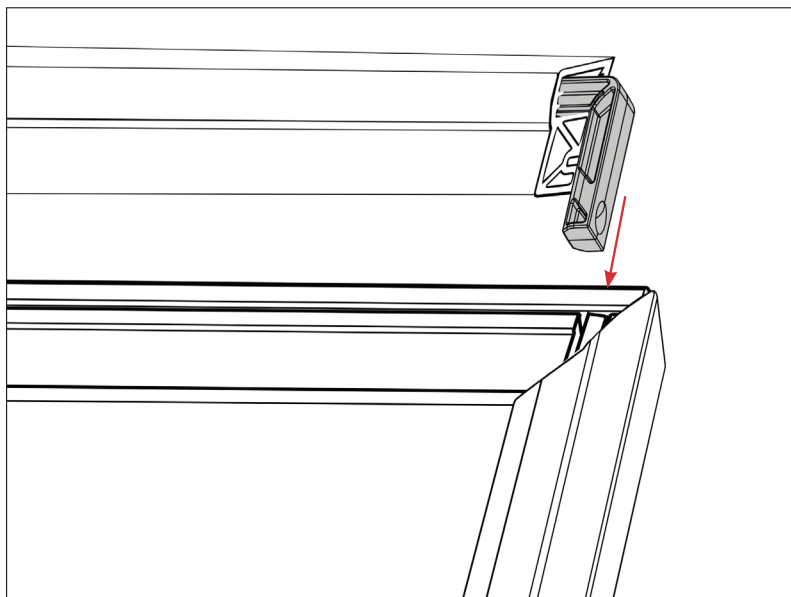

Insert miter keys into both legs.

## STEP 4C: SECURE HEADER

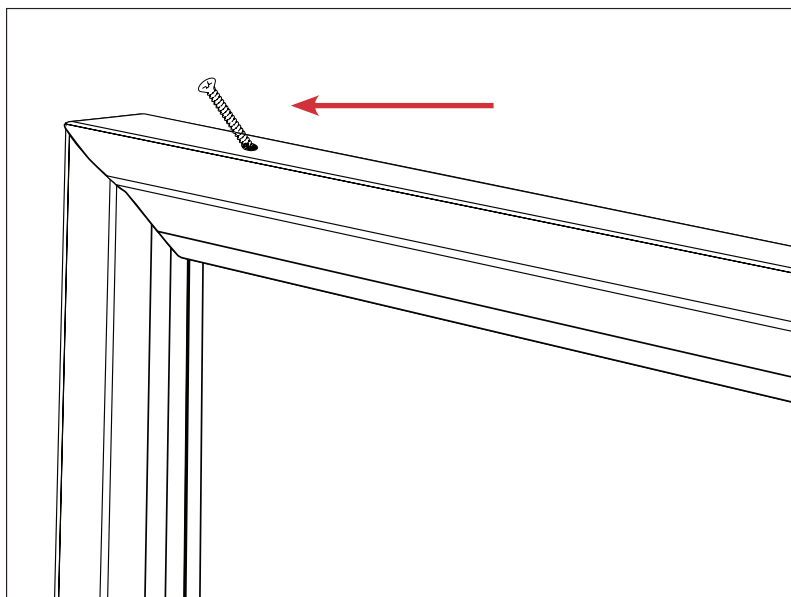

Secure header with 3" drywall or wood screws through the predrilled holes on both sides of the header brickmould.

