



PANOLOCK™

MULTI-POINT LOCK

THE NEW GENERATION OF MULTI-POINT LOCKS

Opportunity Summary

Endura Products is pleased to announce an exciting addition to the Multi-Point Locking family: the PanoLock Multi-Point Locking System. PanoLock is a multi-point lock system that eliminates the most common obstacles related to other multi-point locks on the market by being compatible with off-the-shelf hardware, delivering forgiving performance, and being more cost-effective in the shop, in the field and in our homes.

Multi-point locks are known for enhancing security and performance, but they come with their own set of challenges and issues that impact every stakeholder - from pre-hangers all the way down to the homeowner. Whether it's the high price tag, sensitivity to installation and opening conditions, or the need for dedicated hardware with limited options - other multi-point locks fail to meet the needs of the current market. Raise your expectations when it comes to the performance and affordability of multi-point locks. PanoLock is now the best option on the market for distributors, homeowners, and everyone in between. Whether it's the high price tag, sensitivity to installation and opening conditions, or the need for dedicated hardware with limited options - other multi-point locks fail to meet the needs of the current market. Raise your expectations when it comes to the performance and affordability of multi-point locks. PanoLock is now the best option on the market for distributors, homeowners, and everyone in between.



PanoLock with Bronze Faceplate Finish



PanoLock with Bronze Astragal

The information contained in this document is the confidential and proprietary information and trade secrets of Endura Products, Inc. Any disclosure, use or dissemination of such information without the express written permission of Endura Products, Inc. is strictly prohibited. Endura Products, Inc. also owns any and all intellectual property rights embodied in such information, including patent rights, copyrights, and trademark rights, and no license of any intellectual property right is intended, nor should any license be implied, as a result of the receipt of this document.

Innovation protected under Canadian patent 2,987,618. US patents and additional Canadian patents pending. See www.EnduraPatents.com.

8817 W. Market St., Colfax, NC 27235
 1.800.334.2006
www.enduraproducts.com
www.enduraproducts.com/panolock



Key Features and Benefits

- Hardware Flexibility:** Whether knob, lever, or thumbpress, PanoLock works with most standard/off-the-shelf handlesets through the use of innovative adaptors, providing flexibility and options previously unavailable. As an added benefit, builders no longer have to specify hardware when purchasing the door, and if changes are needed, hardware can be easily and affordably replaced. Compatible brands include: Schlage, Kwikset, Gatehouse, Baldwin, Brinks and Defiant. No dedicated hardware required.
- Shop Efficiency:** PanoLock is compatible with standard 5-1/2" center-to-center crossbores and utilizes a 2-3/8" backset, designed to deliver easy, unrestricted rehanding.
- Real-World Performance:** PanoLock features tapered upper and lower bolts and adjustable reinforcement plates (located beneath the outer strike plates) with built-in rollers, all of which help deliver forgiving performance and smooth operation, even when conditions aren't perfect. Further, PanoLock's adjustable reinforcing Adjustable Roller Plates also include a space for anchor screws for enhanced security.
- Affordability:** PanoLock is offered at a more affordable price point vs other multi-point locks – and not just the lock itself. With simpler routing equipment and compatibility with off-the-shelf handlesets, PanoLock's entire cost of ownership is more approachable, "opening the door" for multi-point locks to be specified for a wider range of projects and budgetary needs.



LEVERS



KNOBES



THUMBPRESSES



Single Operation System

With no extra deadbolt or latch to operate, PanoLock's three locking points activate with a simple turn of the key.



Latch Adapter



Deadbolt Adapter

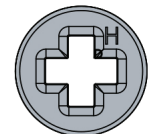
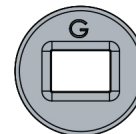
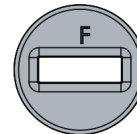
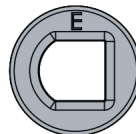
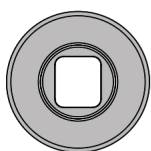

About PanoLock



Adjustable Roller Plate

The lower operation force and rollers within the plates engage with the bolts to make locking and unlocking your door easy, even after years of use.



Tapered Bolt

Unlike other locks that catch easily, PanoLock's tapered bolts deliver a smooth operation even when the door is out of alignment.



PanoLock Offering Specifics:

Lock Faceplate Finishes & Sizing Available

- 6/8 & 8/0
- Bronze Anodize & Brushed Clear Anodize

**All faceplates are available in both 1" or 1 3/8" widths for book or proud edge door panels.*



Bronze Anodize



Brushed Clear Anodize

PanoLock Astragal Finishes & Sizing

- 6/8
- 8/0



Victorian Bronze



Satin Nickel



Bright Brass



Black



Stainless Steel

Lock Handing:

Left Hand, Right Hand (can easily be switched, regardless of how PanoLock is ordered)

Swing: PanoLock can be used for both inswing and outswing.

**Locks can be ordered with right or left handing, inswing or outswing. Handing and swing can be modified in the shop to streamline SKUs.*

Adjustable Strike Plate Finishes:

- Black
- Brass
- Stainless Steel
- Victorian Bronze
- Satin Nickel



Victorian Bronze



Satin Nickel



Bright Brass



Black



Stainless Steel

Testing:

- Torque/Force Testing
- Cycle Testing
- Air & Water Testing
- Structural Testing
- Impact/Force-Entry Testing - Performed as well as Trilennium with ASTM E 30
- FL Impact scheduled to be completed by Feb 2021



The information contained in this document is the confidential and proprietary information and trade secrets of Endura Products, Inc. Any disclosure, use or dissemination of such information without the express written permission of Endura Products, Inc. is strictly prohibited. Endura Products, Inc. also owns any and all intellectual property rights embodied in such information, including patent rights, copyrights, and trademark rights, and no license of any intellectual property right is intended, nor should any license be implied, as a result of the receipt of this document.
Innovation protected under Canadian patent 2,987,618. US patents and additional Canadian patents pending. See www.EnduraPatents.com.

Supporting Components: Endura Router Bit & Routing Template



PanoLock's unique design allows for a straightforward routing process. The router base template is designed to accommodate most routers including Dewalt, Porter Cable, and Milwaukee routers. Endura's custom router bit and cost-effective routing template, retrofitting doors in the field is effortless.

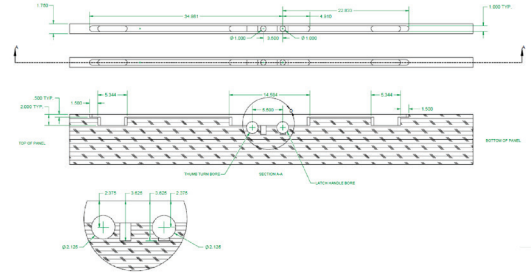

New Product Launch Marketing Support

Ready to reach your customers and spread the word about PanoLock? We're here to help you get the message out with product displays, samples, and branded digital marketing support. For more information, please visit www.enduraproducts.com/panolock/marketing

- Product Display & Sample
- Brochure and Sales Sheet



- Branded Microsite
- Custom Email Blast
- Social Media

