

PanoLock™ Multi-Point Lock Instructions

Frame Machining - Strike Plate Assembly



8817 West Market Street
Colfax, NC 27235 | 800.334.2006
www.enduraproducts.com

⚠ WARNING – Make sure router is unplugged when adjusting bit depth.

⚠ WARNING – Use proper personal protective equipment when operating a router.

Machining details are found in Endura print # 16031-300.

STEP 1

Required tooling includes:

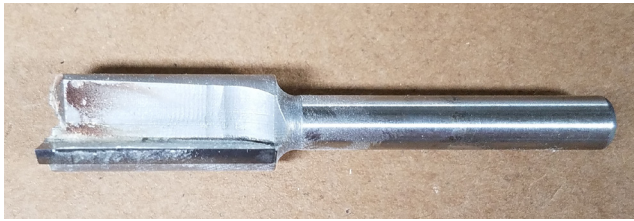

A 1/2" OD x 2" Router Bit



A 5/8" OD Router Guide Collar

STEP 2

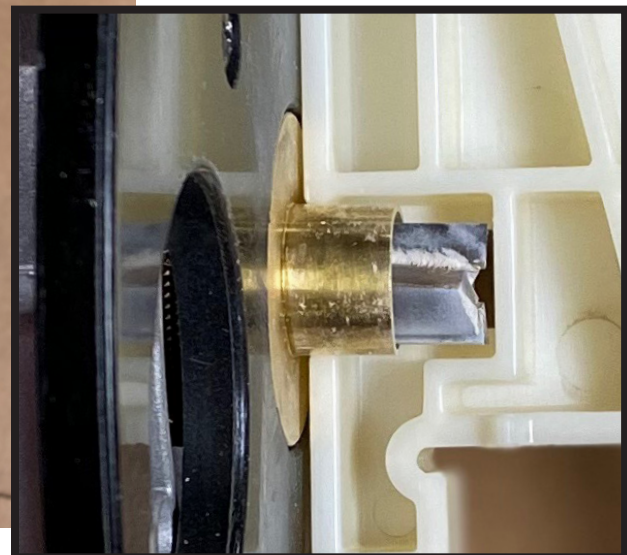
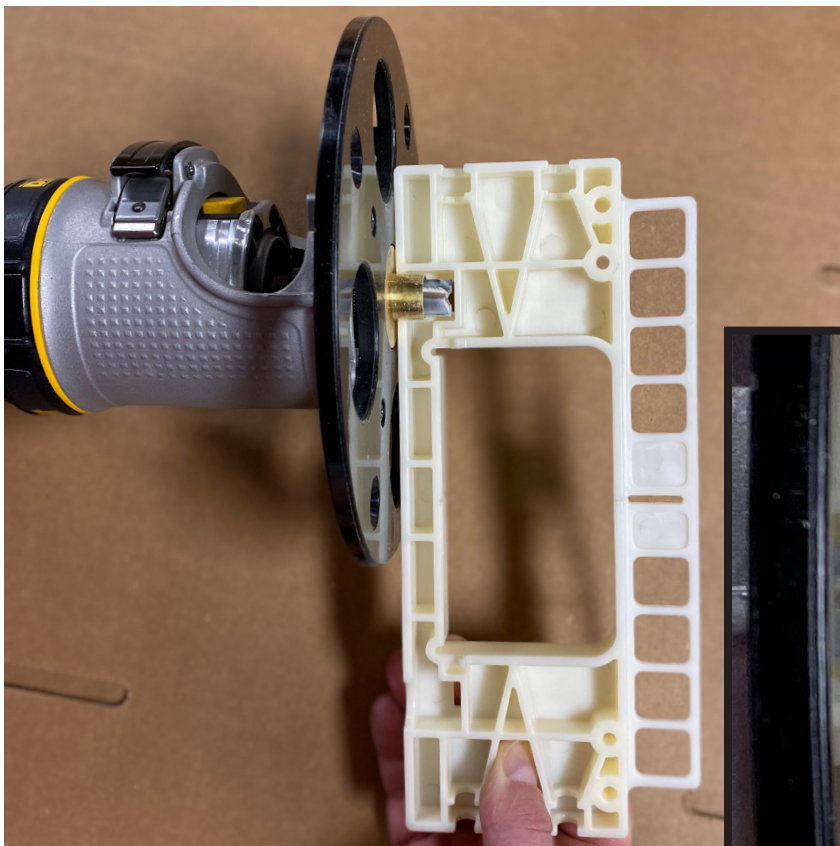

First pocket machining. Set the router bit depth to 25/32" using the guide on the back of the template BASE.

STEP 3

Determine location of middle strike plate.

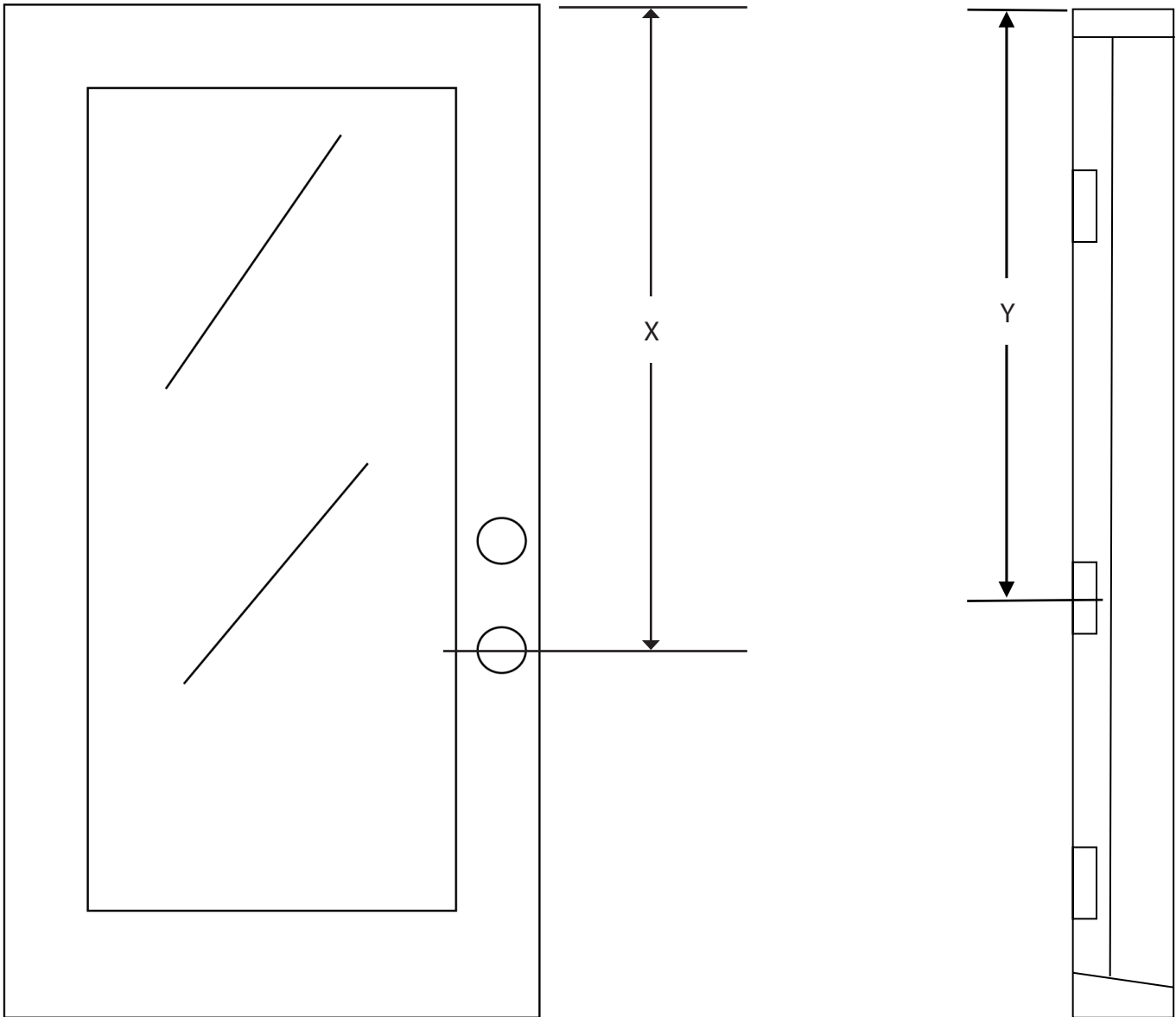

1. Measure from top of door panel to latch bore. This is measurement "X".
2. Take measurement "X" and subtract 2-5/8". This is measurement "Y".
3. From the top of the jamb, measure down "Y" to locate the center of the middle strike plate.

See last page of instruction for spacing between centerlines of each strike plate.

STEP 4

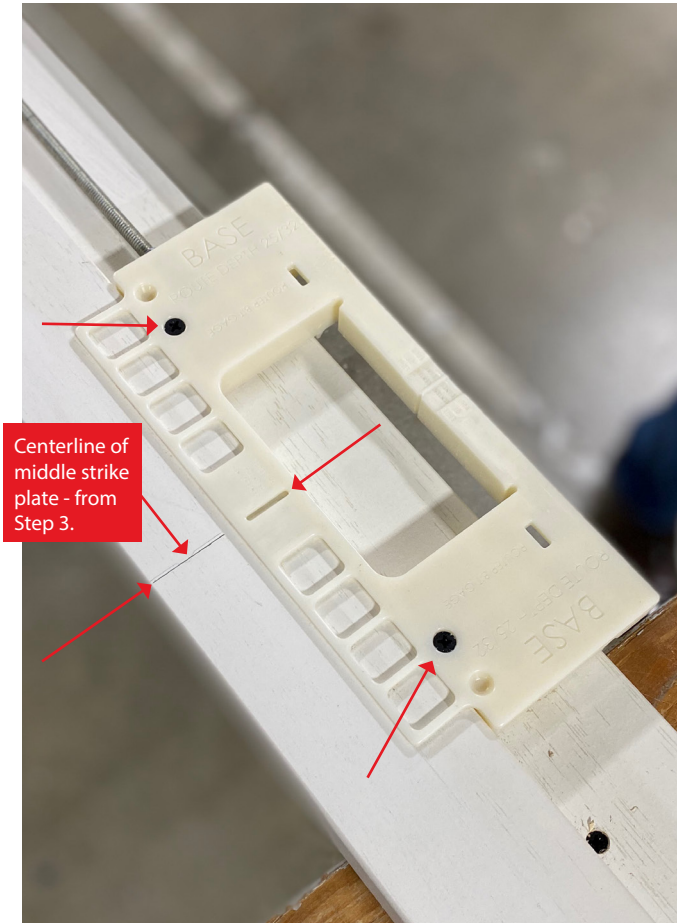

Centerline of middle strike plate - from Step 3.

Locate the template base on the frame as shown. Align the center of the template with the centerline location of the strike plate assembly. Attach the template to the frame with screws, at two locations shown.

STEP 5



Turn router on. Rotate bit into center of template pocket to prevent damaging edge of template. Remove all material within template pocket. Remove all dust and debris from frame.

STEP 6

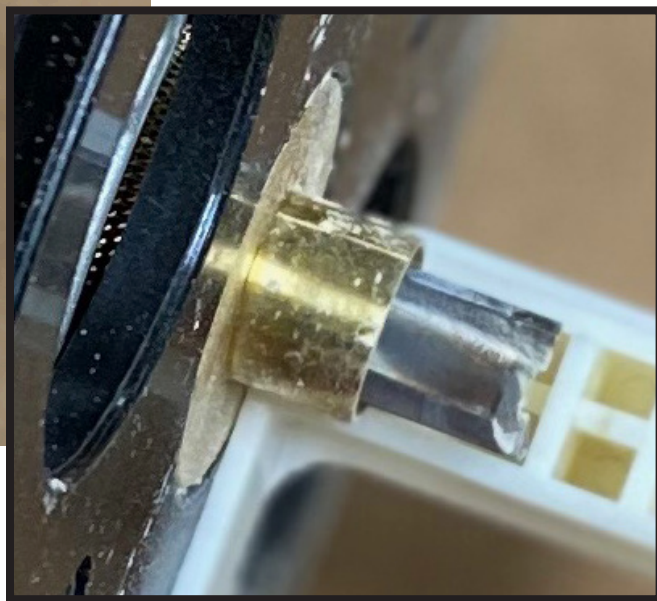
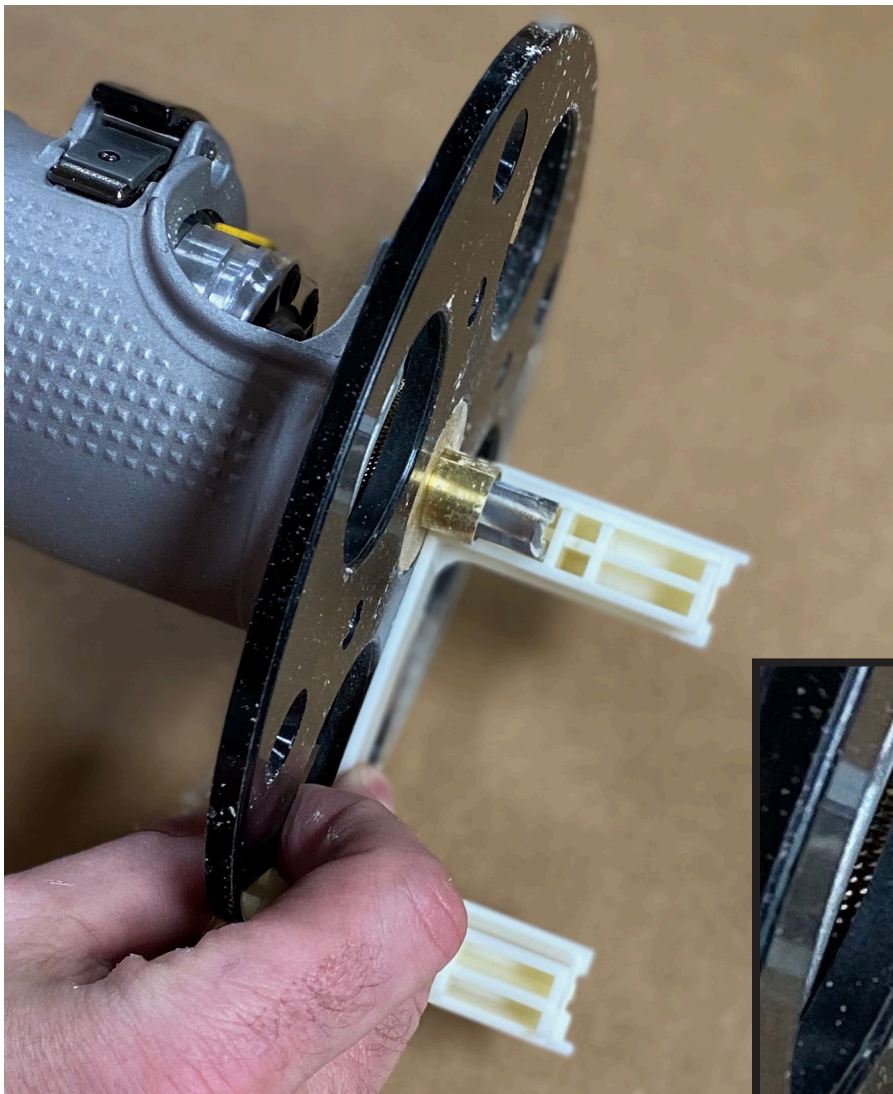

Second pocket machining. Reset the router bit depth to 15/16" using the guide on the back of template INSERT A.

STEP 7

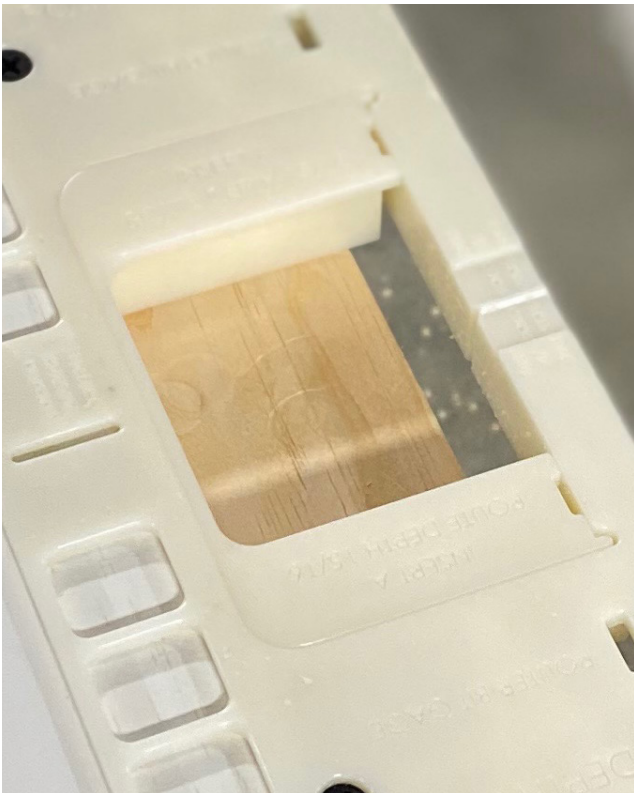
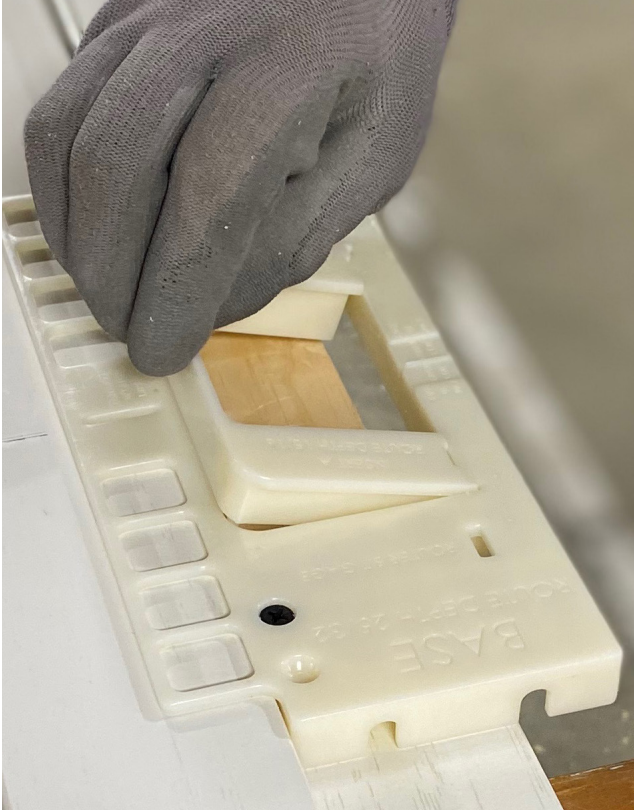

Place INSERT A into template BASE as shown.

STEP 8



Turn router on. Rotate bit into center of template pocket to prevent damaging edge of template. Remove all material within template pocket. Remove all dust and debris from frame.

STEP 9



Third pocket machining. Reset the router bit depth to 1-1/2" using the guide on the front of template INSERT B.

STEP 10

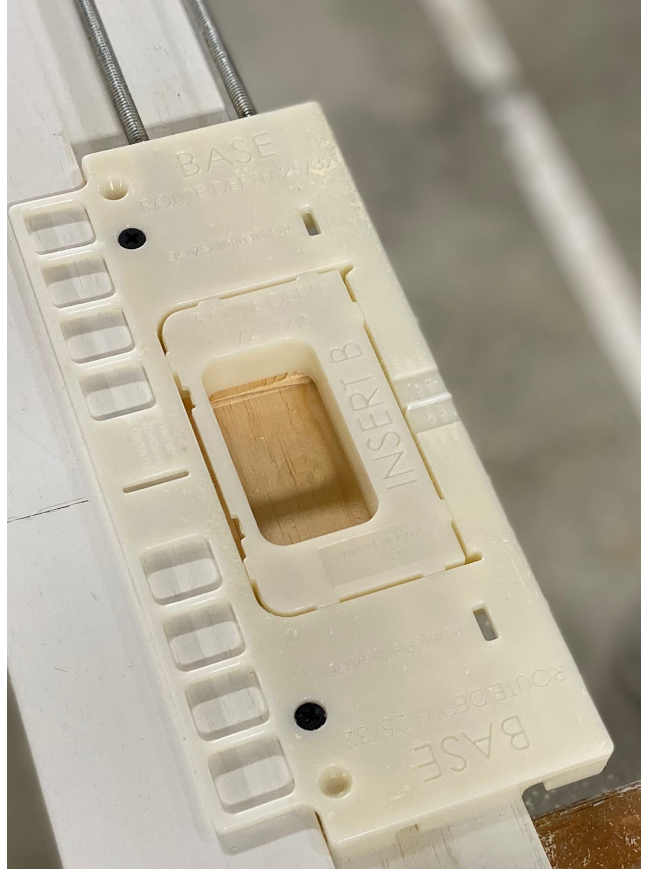

Place INSERT B into template base as shown.

STEP 11



Turn router on. Rotate bit into center of template pocket to prevent damaging edge of template. Remove all material within template pocket. Remove all dust and debris from frame. Strike plate assembly frame mortise is now complete. Repeat steps for remaining pockets.

STEP 12

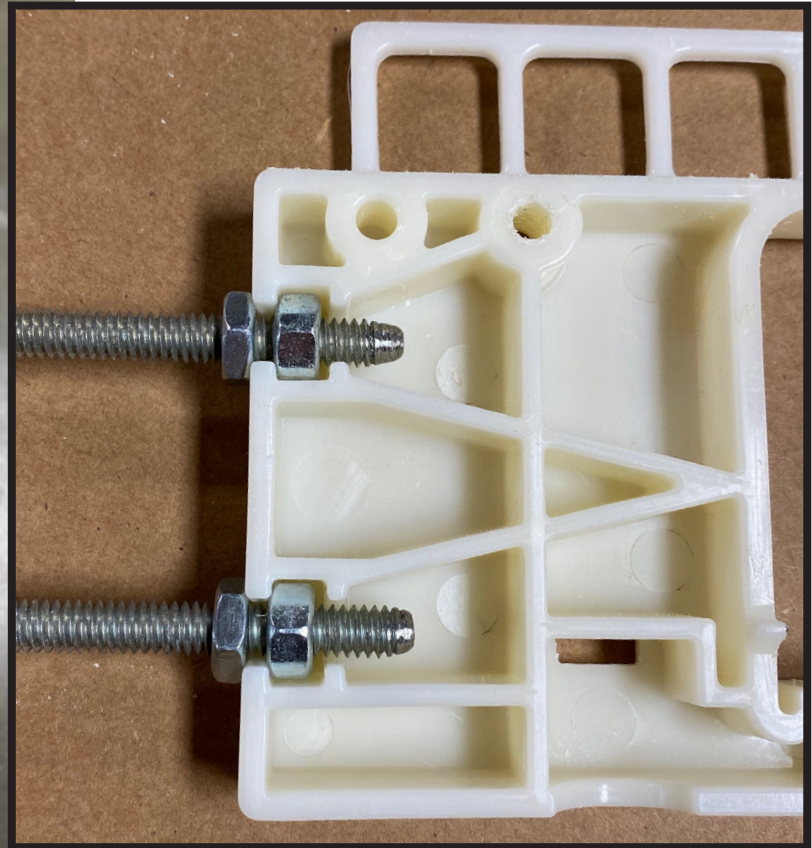
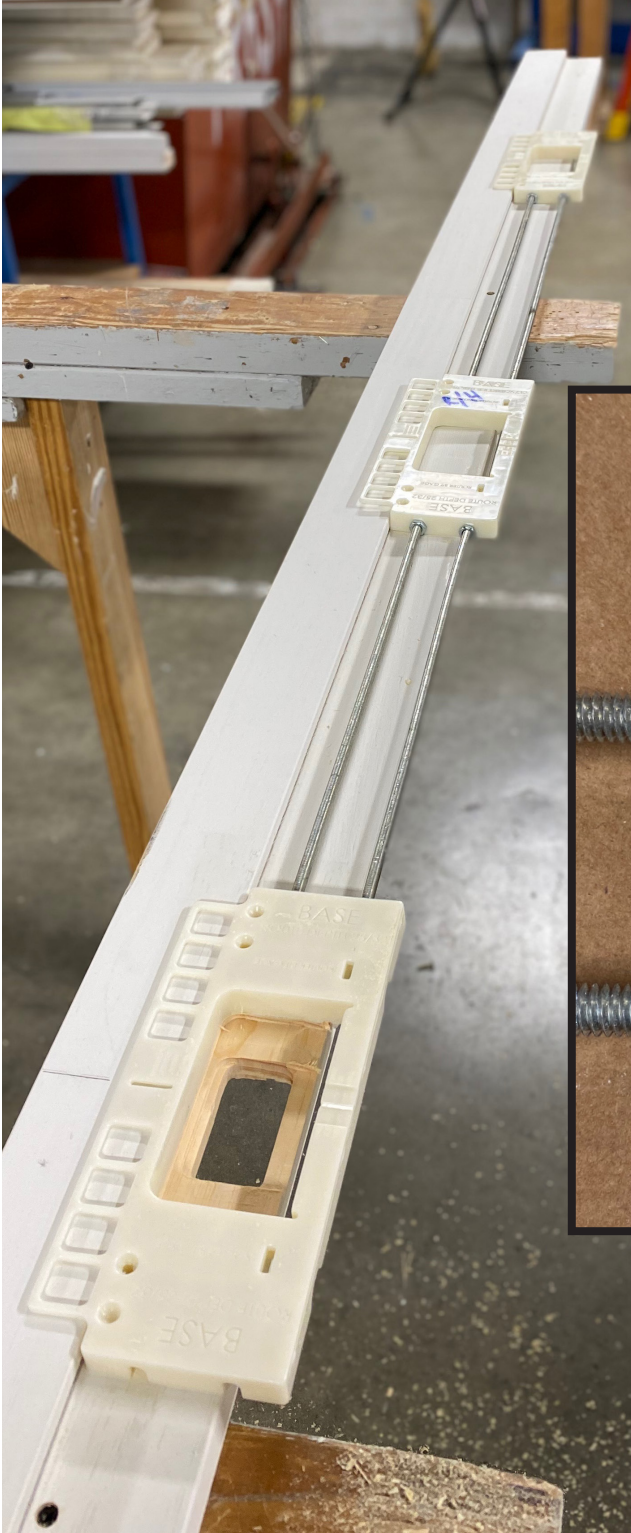

An alternative to moving the routing template for each pocket is to attach template BASES, spaced apart to align with all lock latching points. Using threaded rods and nuts, template BASES can be joined together, and spaced as needed.

| REV | DATE | REVISION DESCRIPTION |
|-----|------|----------------------|
| | | |
| | | |
| | | |
| | | |
| | | |

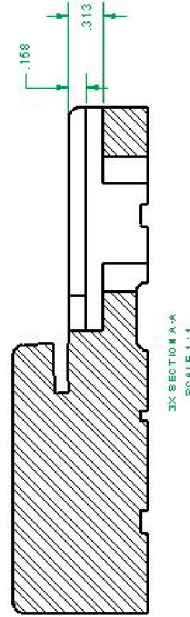
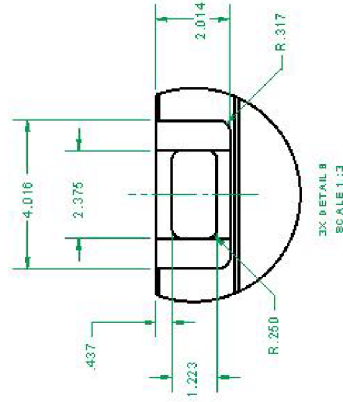
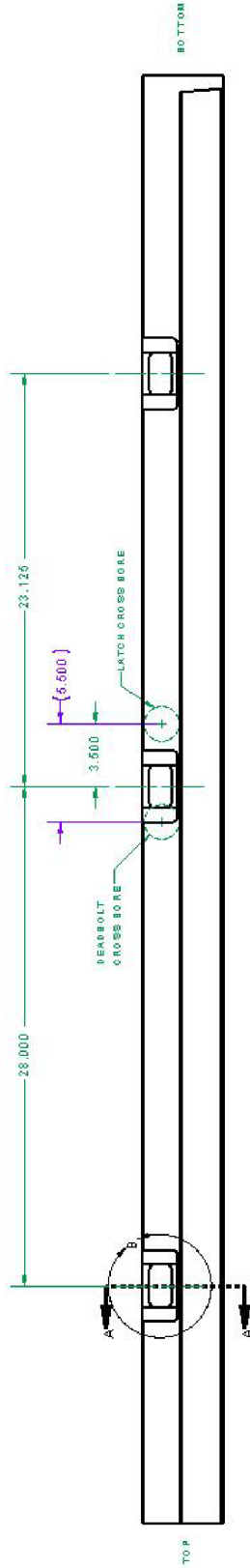

PRELIMINARY

POWERED BY ENDURAM
 ENDURAM INDUSTRIAL MACHINERY
 1000 WASHINGTON BLVD
 NEW YORK, NY 10040-1000
 TEL: 212-351-1000
 FAX: 212-351-1001
 WWW.ENDURAM.COM

68 PANOLock
 STRIKE ROUTE

16031-300 X.001

16031-300 X.001

INSPECTOR DIMENSIONS ARE CIRCLED

PROBES BY Adam Kendall 12/02/18

DATE 12/02/18

SCALE 1:1

16031-300 X.001

16031-300 X.001

16031-300 X.001

16031-300 X.001