

# Inswing to Outswing Conversion Instructions

## Ultimate Astragal

### Outswing Conversion Kit Parts:

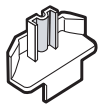

Finned  
Trim Cap

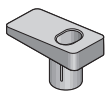

Outswing  
Short Cup



Long Cup

### Outswing Conversion Steps:

- 1** Remove bottom bolt
- 2** Remove bottom trim cap(s)  
Discard large trim cap
- 3** Cut 9/16" from bottom of astragal body, large side only.  
  
Remove all chips and debris.
- 4** Install finned trim cap  
Reinstall (if present) small trim cap
- 5** Reinstall bottom bolt
- 6** Install sill cup according to Steps 7, 7a, 7b.

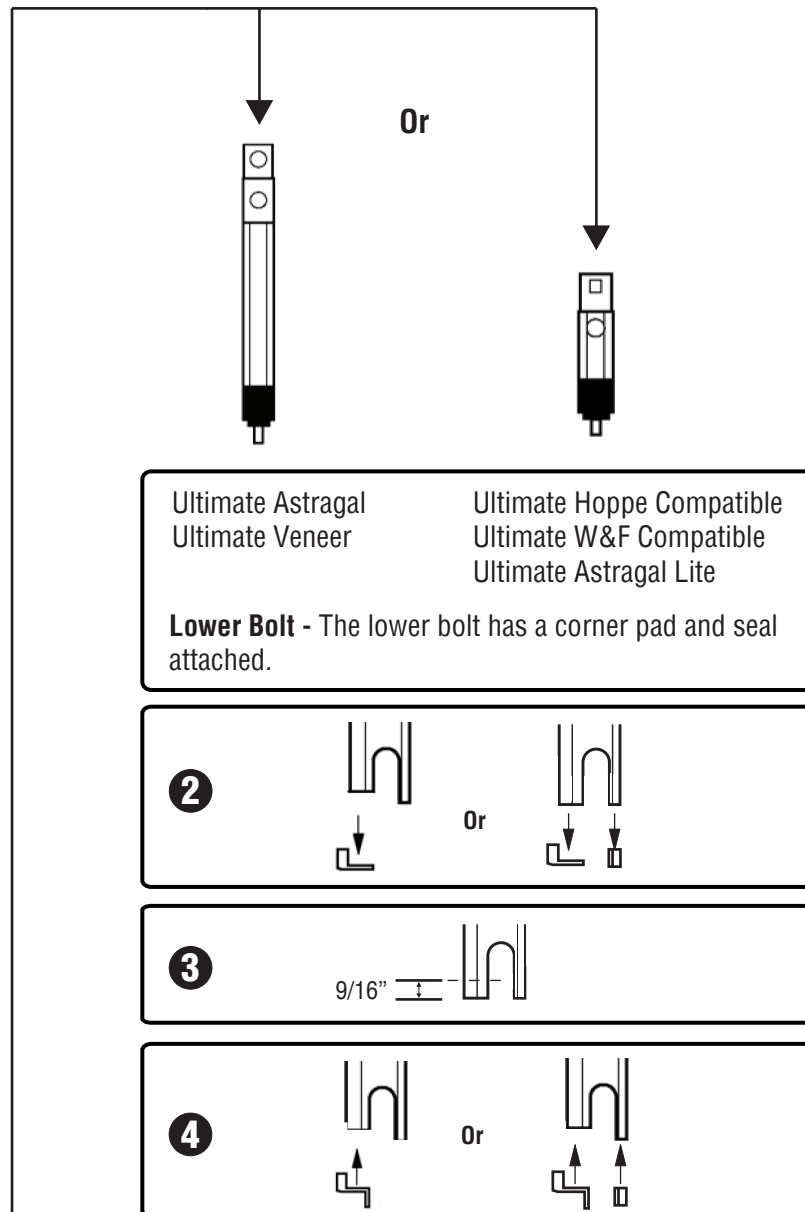
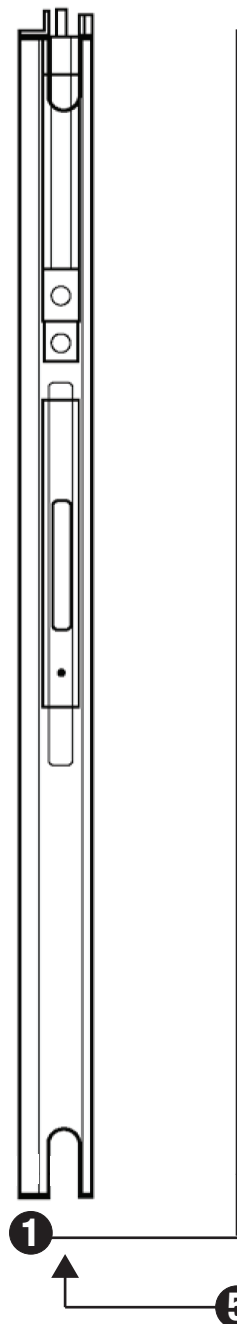

# Inswing to Outswing Conversion Instructions

## Ultimate Astragal

**Endura**  
DOOR COMPONENT SYSTEMS  
800.334.2006  
8817 West Market Street  
Colfax, NC 27235

### Recommended Installation Method (Step 7)

Utilizing long cup

### Alternative Installation Method (Use steps 7a, 7b)

Utilizing short cup

**WARNING:** If you choose the alternative installation method, this will void your warranty.

## 7 Position and Install Bolt Retainers

**NOTE:** To insure accurate hole locations for the astragal bolt retainers, first properly install corner pad on door hinge jambs to establish proper jamb side margins.

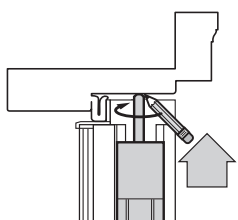

Close passive door until header weatherstrip is compressed. Push bolt pins to contact header and sill. Mark for drilling retainer holes.

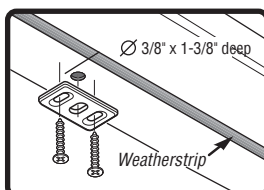
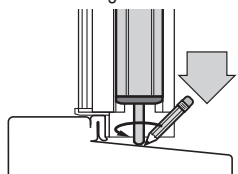

#### HEADER:

Drill a  $\varnothing 3/8"$  hole (1-3/8" deep minimum) into the header where marked. Attach the Upper Retainer with screws provided.

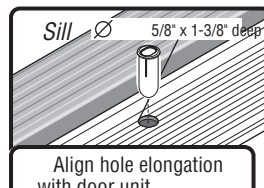

#### SILL:

Drill a  $\varnothing 5/8"$  hole (1-3/8" deep minimum) in the sill at the marked location. Apply a bed of sealant to bottom of drilled hole. Insert Lower Retainer, orienting the long side of the hole parallel to the sill cap (as shown) and tap into place with a mallet.

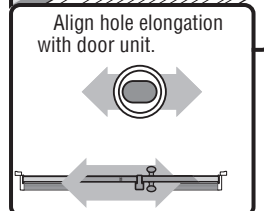

## 7a Position and Install Bolt Retainers

**NOTE:** To insure accurate hole locations for the astragal bolt retainers, first properly install corner pad on door hinge jambs to establish proper jamb side margins.

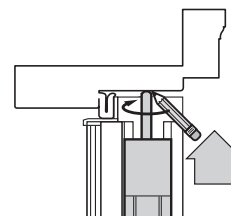

Close passive door until header weatherstrip is compressed. Push bolt pins to contact header and sill. Mark for drilling retainer holes.

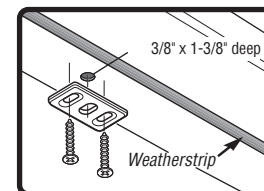
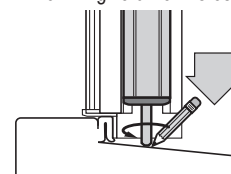

#### HEADER:

Drill a  $\varnothing 3/8"$  hole (1-3/8" deep minimum) into the header where marked. Attach the Upper Retainer with screws provided.

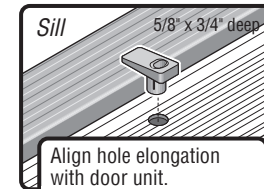

#### SILL:

Drill a  $\varnothing 5/8"$  hole (3/4" deep minimum) in the sill at the marked location. Apply a bed of sealant to bottom of drilled hole. Insert Lower Retainer, orienting the long side of the hole parallel to the sill cap (as shown) and tap into place with a mallet.

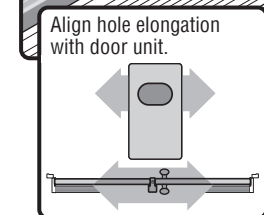

## 7b Do Not Cut More Than 3/4" Off Strike Support

If you choose to use your locking mechanism when using the short cup the strike support must be cut as follows:

- Cut 3/4" inch off strike support

**Note:** If you cut beyond 3/4" inch then you risk the bolt becoming disengaged with the strike support.

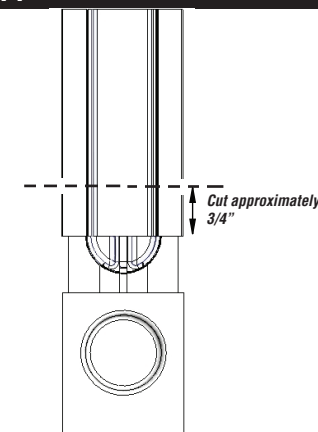

**NOTE:** Steps 7a and 7b are for the alternative installation method that utilizes the short cup. Using this method will void your warranty.