

Field Installation Instructions

MULTI-POINT ASTRAGAL

800.334.2006
8817 West Market Street
Colfax, NC 27235

Endura[™]
PERFORMANCE STANDARD

Note: Follow these instructions after the door unit has been fastened to the rough opening

1 Position and Install Bolt Retainers

NOTE: To ensure accurate hole locations for the astragal bolt retainers, first properly install corner pad on door hinge jambs to establish proper jamb side margins.

contact header approx.
7/8" from jamb stop

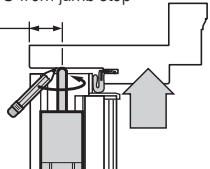

Close passive door until header weatherstrip is compressed. Push bolt pins to contact header and center of sill cap and mark for drilling retainer holes.

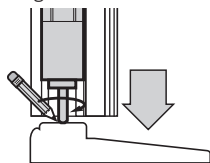

contact sill cap approx.
7/8" from back of cap nosing

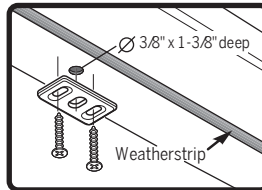

HEADER:

Drill a Ø 3/8" hole (1-3/8" deep minimum) into the header where marked. Attach the Upper Retainer with screws provided.

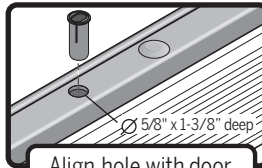

SILL:

Drill a Ø 5/8" hole (1-3/8" deep minimum) in the sill at the marked location. Insert Lower Retainer, orienting the long side of the hole parallel to the sill cap (as shown) and tap into place with a mallet.

Align hole with door unit as shown

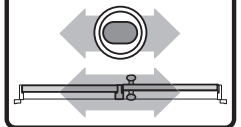

Outswing

NOTE: To insure accurate hole locations for the astragal bolt retainers, first properly install corner pad on door hinge jambs to establish proper jamb side margins.

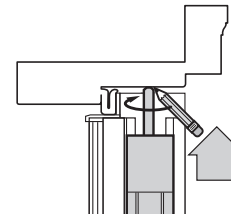

Close passive door until header weatherstrip is compressed. Push bolt pins to contact header and sill. Mark for drilling retainer holes.

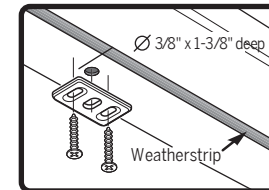
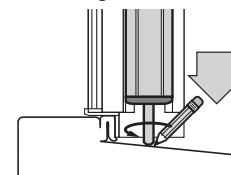

HEADER:

Drill a Ø 3/8" hole (1-3/8" deep minimum) into the header where marked. Attach the Upper Retainer with screws provided.

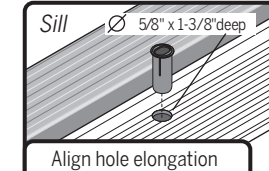

SILL:

Drill a Ø 5/8" hole (1-3/8" deep minimum) in the sill at the marked location. Apply a bed of sealant to bottom of drilled hole. Insert Lower Retainer, orienting the long side of the hole parallel to the sill cap (as shown) and tap into place with a mallet.

Align hole elongation with door unit.

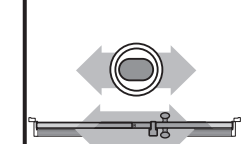

2 Cut Weatherstrip at Header

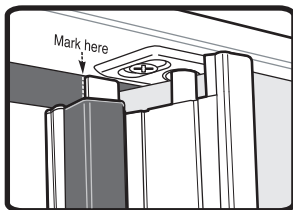

Step 1: With inactive door closed, use a sharp utility knife to mark the location on the header weatherstrip to be cut. The cut should be in line with the active door side edge of the trim cap fin.

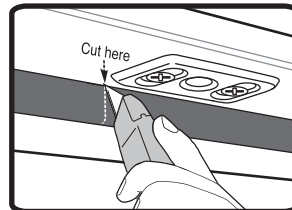

Step 2: Open the inactive door, then use the utility knife to cut the header weatherstrip flexible leg on the mark made in Step 1.

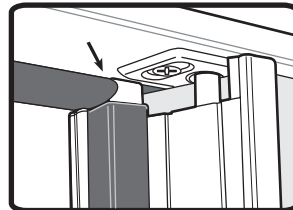

Result: Header weatherstrip should now clear the trim cap fin and contact the active door maintaining the integrity of the seal.

3 Remove Hardware Cover After Painting

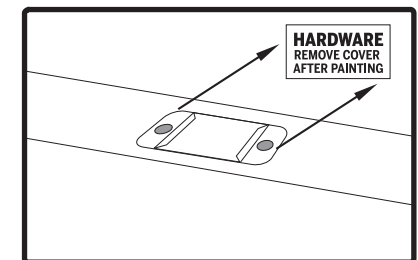
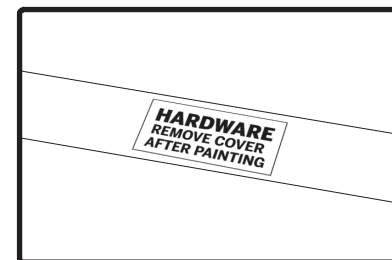

NOTE: If the deadbolt does not properly align with the actuator hole, contact the door pre-hanger for assistance.

4 Adjust Deadbolt Lock Actuator - Remove Center and Loosen Actuator

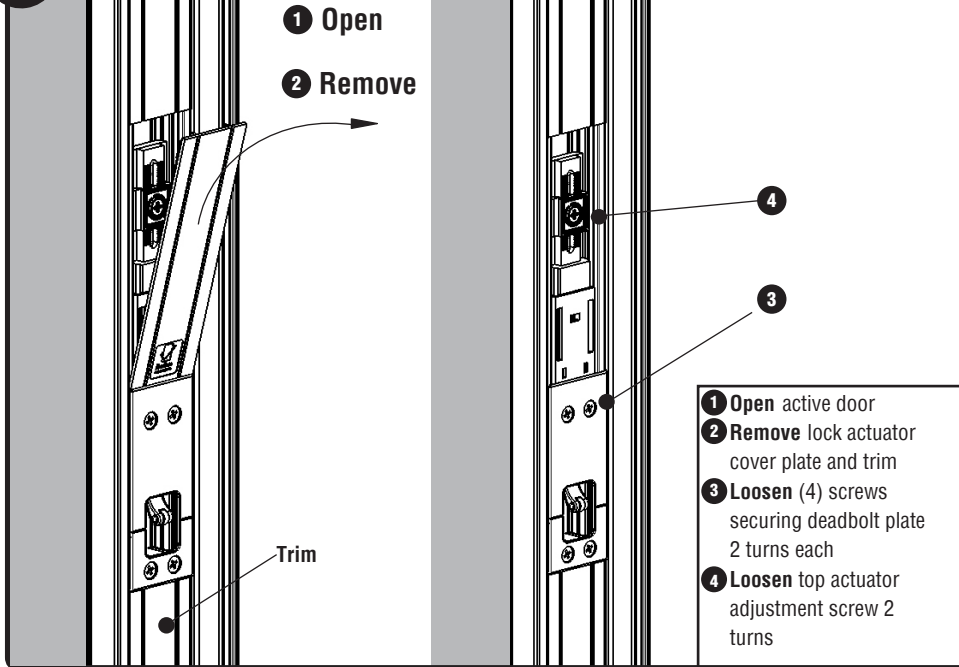

5 Adjust Deadbolt Lock Actuator - Secure Actuator

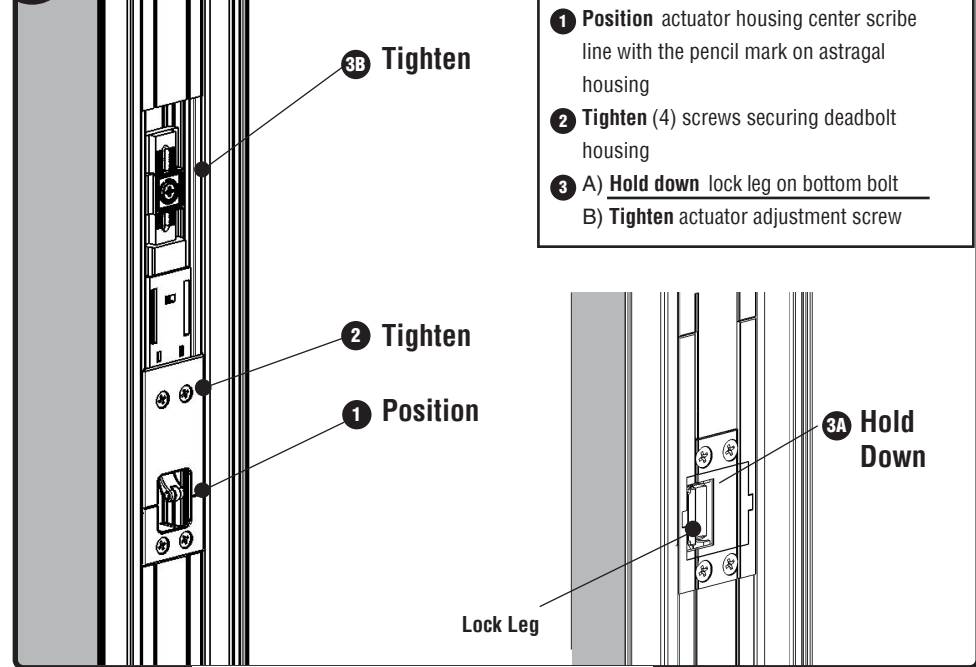

6 Replace Actuator Cover

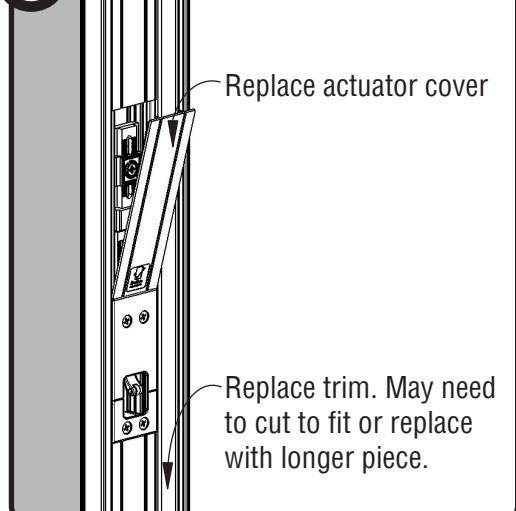

7 Close Door and Replace Body Trim

