

## 1 Position and Install Bolt Retainers

**NOTE:** To insure accurate hole locations for the astragal bolt retainers, first properly install corner pad on door hinge jambs to establish proper jamb side margins.

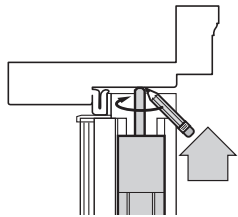

Close passive door until header weatherstrip is compressed. Push bolt pins to contact header and sill. Mark for drilling retainer holes.

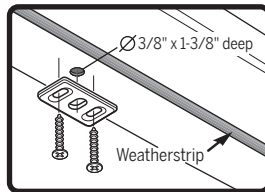
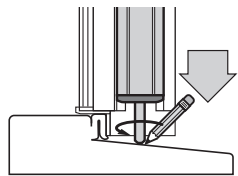

**HEADER:**

Drill a  $\text{Ø}3/8$ " hole (1-3/8" deep minimum) into the header where marked. Attach the Upper Retainer with screws provided.

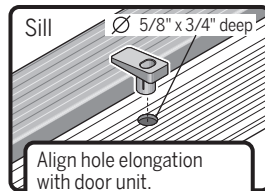

**SILL:**

Drill a  $\text{Ø}5/8$ " hole (3/4" deep minimum) in the sill at the marked location. Insert Lower Retainer, orienting the long side of the hole parallel to the sill cap (as shown) and tap into place with a mallet.

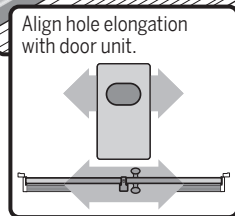

## 3 Slice Weatherstrip at Header

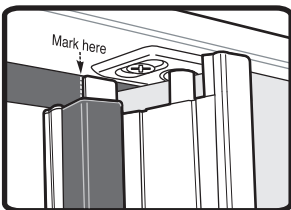

**Step 1:** With inactive door closed, use a sharp utility knife to mark the location on the header weatherstrip to be cut. The cut should be in line with the active door side of the trim cap fin.

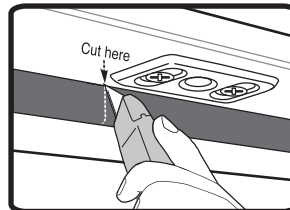

**Step 2:** Open the inactive door, then use the utility knife to cut the header weatherstrip on the mark made in Step 1.

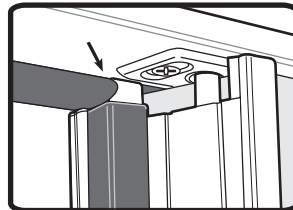

**Result:** Header weatherstrip should now clear the trim cap fin and contact the active door maintaining the integrity of the seal.

## 2 Adjusting Strike and Deadbolt Plates Position

Close both doors. Mark desired positions for strike and deadbolt plates. Loosen the retainer screws. Remove temporary plates provided by manufacturer, and replace with desired strike and deadbolt plates. Place the strike and deadbolt plates into position and tighten the screws.

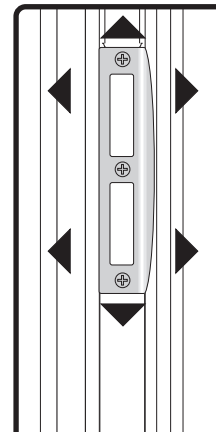

Check positions and adjust as needed.

