

# Z-Full Narrow (FN) Sill

Performance Standard 

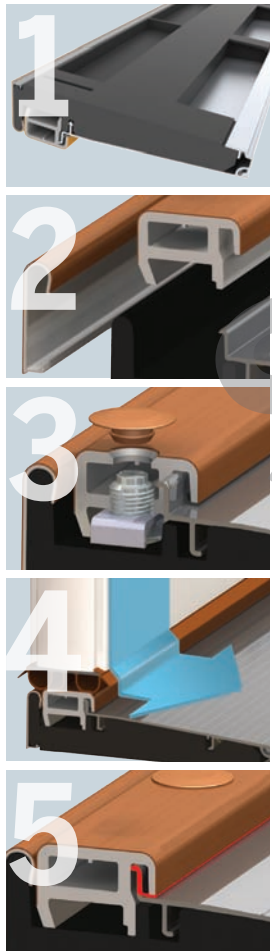

Z-FN Full Narrow Substrate



- 1. Composite Substrate**  
No more stuck doors or drafts because the Z-Series Full Narrow (FN) substrate material is a waterproof composite that won't rack, warp or rot, ever.
- 2. Composite Cap and Nosing**  
Extruded cap and nosing finishes look great and resist wear and discoloration. The synthetic material used in the cap and nosing prevent warping, rotting and wear.
- 3. Sealed Adjustment Screws**  
Patented sealing plugs hide unsightly screws and keep water and dirt away from the adjustment mechanism, maintaining adjustability of the sill cap over time.
- 4. Narrow Cap**  
Because of the narrow threshold cap, the drip edge on the door bottom deflects water a full 1/4" in front of the cap, protecting against air and water infiltration.
- 5. High Dam, Integrated Seal**  
A dual durometer cap seal overlaps the high dam. Both combine to provide a barrier to air and moisture even in the most extreme weather conditions.

## Why buy a Z-Full Narrow (FN) Sill

Featuring a cost-effective full narrow substrate with full support, aesthetic decorative nosing and a wide range of sizes for a uniform look in all entries.

## Features

- Full width support up to 7-13/16"
- Full-length caulking surface
- CSL up to 1/2-3/0-1/2; hinged patio up to 3/0-3/0
- Easily converts from inswing to outswing
- Length up to 6'-0"
- Patented performance—U.S. Patents: 5, 426, 894; 5, 588, 266; 5, 611, 173, 6, 789, 358; 7, 350, 336; D354, 572



### Availability

Available in 4-9/16", 5-5/8" and 7-13/16" sill widths.

### Sill Cover

Durable patented sill covers, provide protection against damage to the sill during construction. Available in the following sizes: 4-9/16", 5-5/8" and 7-13/16".



Z-Full Narrow (FN) Substrate

### Sill Extender Cavity Feature

The sill extender cavity feature is available on 4-9/16" and 5-5/8" sills and accommodating sill extenders.

### Bumper Outswing Cap

Deck cap design allows removal of the inswing adjustable cap and replacement with a bumper outswing cap.

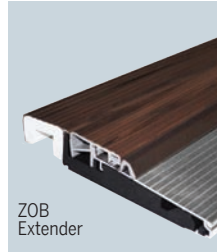

ZOB Extender



Sill Cover



Z-Full Narrow (FN) Sill Outswing

### Specifications Overview

● Standard    ● Option    ○ Not Available

#### Structure

Composite Substrate	●
Int. Thermal Break	●

#### Cap Colors

Black	●
Dark Walnut	●
Castle Oak	●
Mill	○
Bronze	○

#### Sill Width

3-1/2"	○
3-11/16"	●
3-3/4"	○
4-9/16"	●
5-5/8"	●
5-13/16"	○
7-13/16"	●

#### Sill Cover Width

3-11/16"	○
4-9/16"	●
5-5/8"	●
5-13/16"	○
7-13/16"	●

#### ZOB 2" Extender

Black, Walnut	●
---------------	---

#### Cutability

2/6	Min	29.875"	
	Max	30.3125"	
2/8		Cuttable to 2/6?	✓
	Min	31.875"	
	Max	32.3125"	
2/10	Min	N/A	
	Max	N/A	
3/0		Cuttable to 2/8?	✓
		Cuttable to 2/10?	✓
	Min	35.875"	
	Max	36.3125"	
3/4-3/6	Min	N/A	
	Max	N/A	
5/0	Min	57.9375"	60.1875"
	Max	59.750"	62"
5/4	Min	61.9375"	64.1875"
	Max	63.750"	66"
6/0	Min	69.9375"	72.1875"
	Max	71.750"	74"
0/10-3/0-0/10	Min	58.9735"	
	Max	61.8125"	
1/0-3/0-1/0		Cuttable to 0/10?	✓
	Min	61.8125"	
	Max	63.250"	
1/2-3/0-1/2		Cuttable to 1/0?	✓
	Min	65.8125"	
	Max	67.250"	
1/4-3/0-1/4	Min	N/A	
	Max	N/A	
2/6-2/6	Min	57.9375"	60.1875"
	Max	59.750"	62"
2/8-2/8	Min	61.9375"	64.1875"
	Max	63.750"	66"
3/0-3/0	Min	69.9375"	72.1875"
	Max	71.750"	74"
3/0-3/0-3/0	Min	N/A	
	Max	N/A	
3/0-3/0-3/0-3/0	Min	N/A	
	Max	N/A	

#### Deck Color Options

	Mill	Bronze	Brass	Nickel
3-1/2" (Screw Boss)	○	○	○	○
3-11/16"	●	●	○	○
3-3/4" (Screw Boss)	○	○	○	○
4-9/16"	●	●	○	○
5-5/8"	●	●	○	○
5-13/16"	○	○	○	○
7-13/16"	●	●	○	○

#### Aluminum Deck Colors

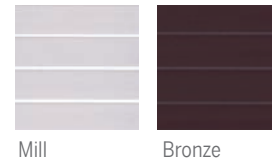

Mill      Bronze

#### Co-Extruded Simulated Wood Caps

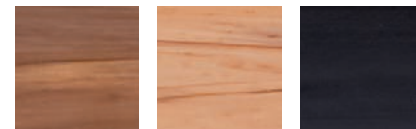

Walnut      Castle Oak      Black



PERFORMANCE STANDARD

8817 W. Market St., Colfax, NC 27235  
**1.800.334.2006** www.enduraproducts.com

Contact us for more information.

The information contained in this document is the confidential and proprietary information and trade secrets of Endura Products, Inc. Any disclosure, use or dissemination of such information without the express written permission of Endura Products, Inc. is strictly prohibited. Endura Products, Inc. also owns any and all intellectual property rights embodied in such information, including patent rights, copyrights, and trademark rights, and no license of any intellectual property right is intended, nor should any license be implied, as a result of the receipt of this document.