

## Ultimate Astragal Lite/ Multi-Point Compatible Astragal

### Outswing Conversion Kit Parts:



### Outswing Conversion Steps:

- 1** Remove trim caps and flush bolts
- 2** Cut **9/16"** notch from wide portion of astragal bottom only.
- 3** Replace flush bolts and trim caps (**substituting the large finned outswing cap for the flat inswing cap at bottom of astragal**)
- 4** Hang astragal on door (**reference outswing installation instructions**) and drill hole in sill for outswing flush bolt pin retainer

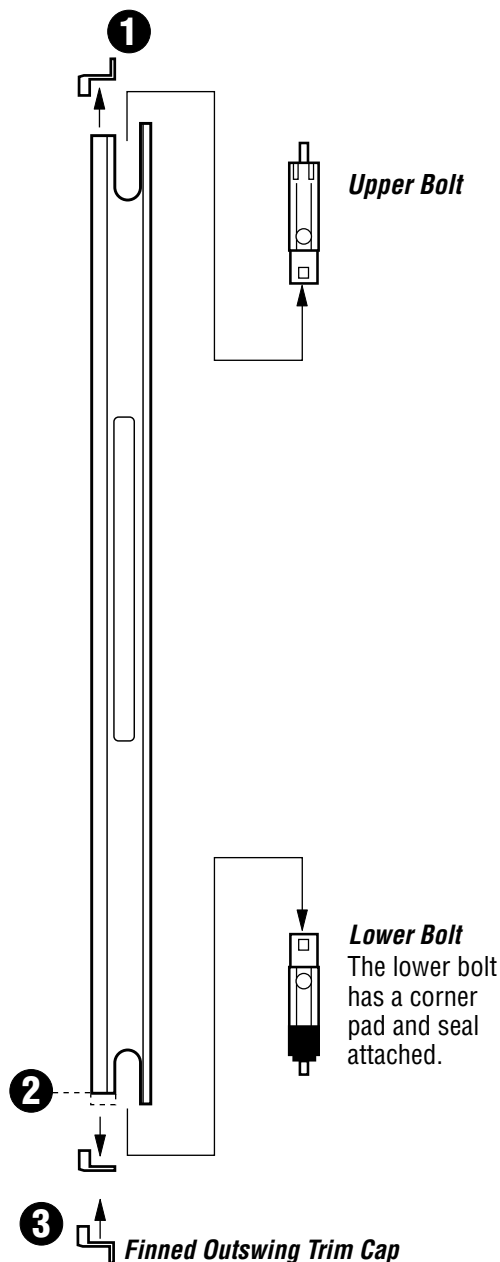

### **4** Drilling sill for outswing retainer

Close door with astragal until header weatherstrip is compressed. Push bolt pins to contact the sill. Mark for drilling retainer hole.

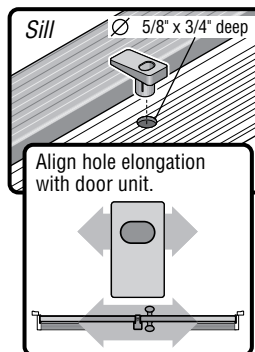
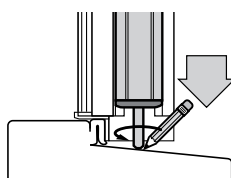

Drill a **Ø 5/8"** hole (**3/4"** deep minimum) in the sill at the marked location. Insert Lower Retainer, orienting the long side of the hole parallel to the sill cap (as shown) and tap into place with a mallet.