

Outswing Conversion Instructions

Ultimate Astragal

Endura
DOOR COMPONENT SYSTEMS
800.334.2006
8817 West Market Street
Colfax, NC 27235

Outswing Conversion Kit Parts:

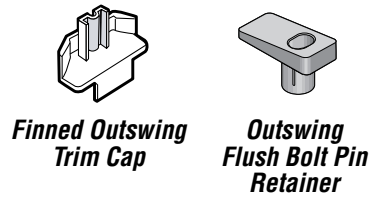

Outswing Conversion Steps:

- 1** Remove trim caps, flush bolts and strike support
- 2** Cut off **9/16"** from bottom of astragal
- 3** Replace flush bolts, strike support and trim caps (**substituting the large finned outswing cap for the flat inswing cap at bottom of astragal**)
- 4** Hang astragal on door (**reference outswing installation instructions**) and drill hole in sill for outswing flush bolt pin retainer

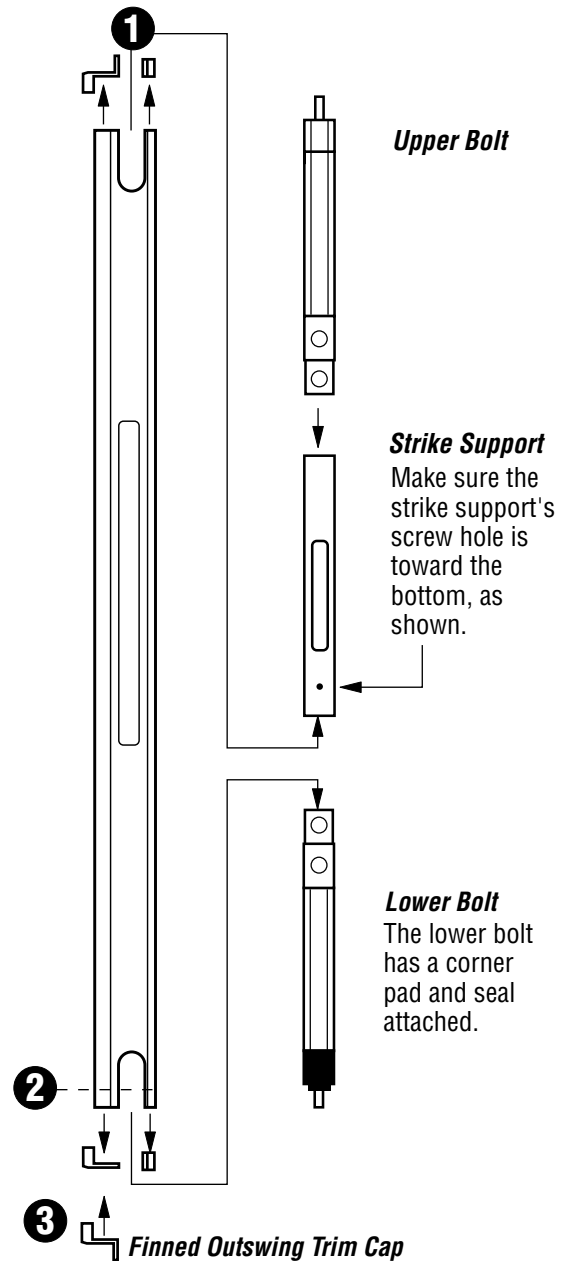

4 Drilling sill for outswing retainer

Close door with astragal until header weatherstrip is compressed. Push bolt pins to contact the sill. Mark for drilling retainer hole.

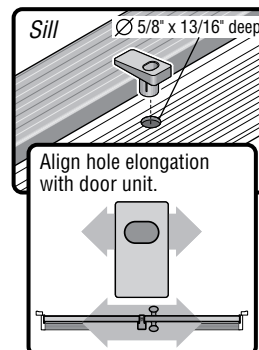
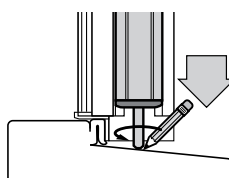

Drill a $\varnothing 5/8"$ hole (**13/16" deep minimum**) in the sill at the marked location. Insert Lower Retainer, orienting the long side of the hole parallel to the sill cap (as shown) and tap into place with a mallet.