

Maintenance-Free Outswing Pre-Finished Door Systems

Installation Instructions

These instructions apply to the following Door System Configurations

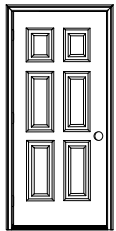

Single Doors

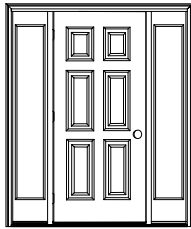

Single & Double
Continuous
Sidelite Units

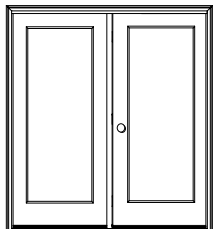

French &
Patio Units

It's how doors work.™



8/26/04

1 Preparing the Rough Opening

- ② Are the walls straight?
- ② Are the studs plumb and level?
- ② Is the subfloor clean, dry, level and solid?

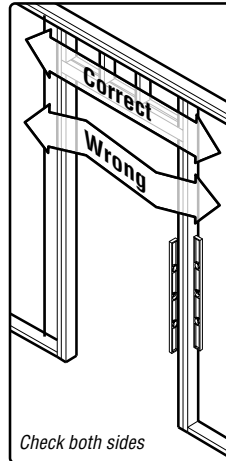

If you are using a height plate to bring the sill up to the level of the finished floor covering:

Be sure that it is at least as wide as the sill and as long as the rough opening.

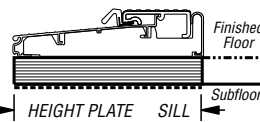

Be sure to caulk thoroughly under and around the height plate.

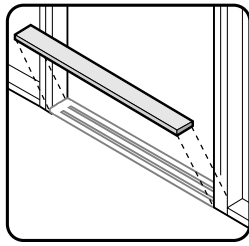

2 Pre-Caulking Subfloor for Sill

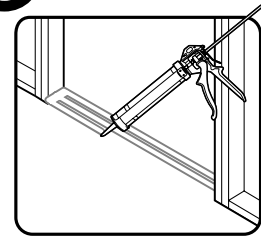

Put three heavy beads (1/2" wide) of silicone caulk on the subfloor or height plate as shown. Put enough caulk at the sides to completely cover the bottom of the side jamb. Pivot door unit directly into position.

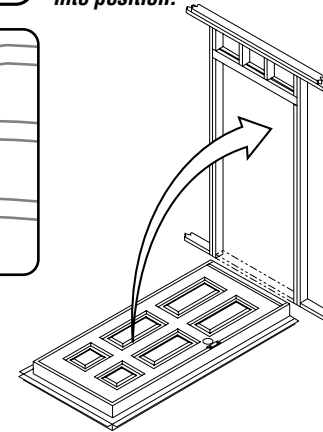
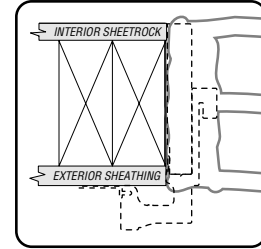

3 Position Unit in Rough Opening

Secure fasteners through jambs on the hinge jamb. Do not fully seat.

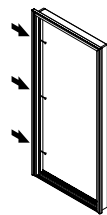

Single Units:
Fasten Hinge
Jamb

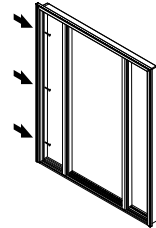

Sidelite Units:
Fasten Sidelite
Jamb to Hinge Jamb

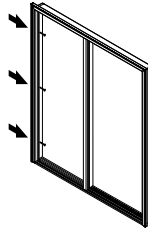

French & Patio Units:
Fasten Jamb on fixed
or passive side of door

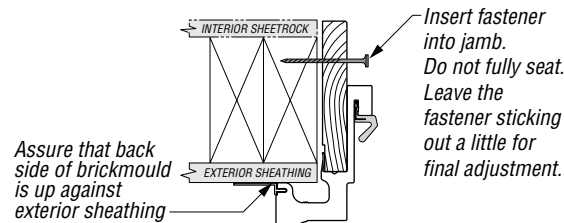

4 Shim and Secure Hinge Jamb

Check hinge jamb for plumb and true with a 6-foot level.

If necessary, on hinge jamb only: Place one shim behind each hinge between the hinge jamb and the wall stud.

Drive a fastener through each shim and remove excess shim.

Drive nails through holes in nailing flange.

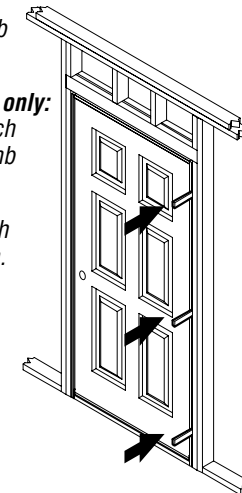
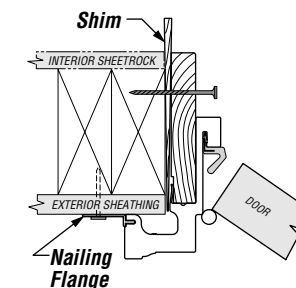

Endura
It's how doors work.™

P.O. Box 8908, Greensboro, NC 27419-0908

800-334-2006

Customer Service Fax: 336-668-4478

Email: sales@enduraproducts.com

www.enduraproducts.com

5 Ensure Consistent Margins

Shim between **strike** side jamb and wall stud near the top and bottom of jamb, across from top and bottom hinge locations.

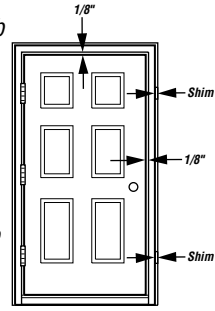

Adjust the frame so it is flush with the face of the door.

Margins between door and frame should be 1/8" on top and strike side.

Check the weatherstrip contact for even compression all around the door.

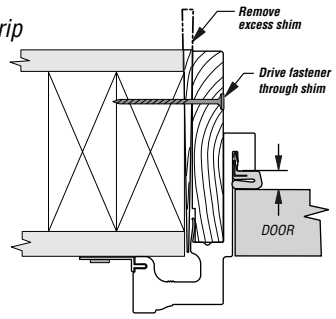

Drive fasteners through jambs at locations of top and bottom shims, then remove excess shims.

6 Applying Hinges and Lockset Hardware

Remove the top screw from each hinge and replace with a #10 x 2-1/2" screw. These screws will run through hinge jamb and into the wall stud, preventing door sag.

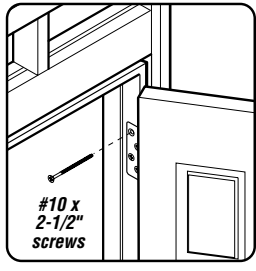

Install lockset hardware.

With door closed, shim behind latch area to maintain proper margins.

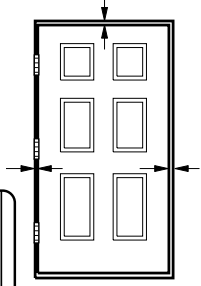

Attach the strike plate with two #10 x 2-1/2" screws through the shim and into the wall stud. Remove excess shim.

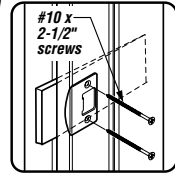

7 Fastening Header

Secure fasteners through thin part of header at pre-drilled holes provided. Use shim at each location to maintain proper margin.

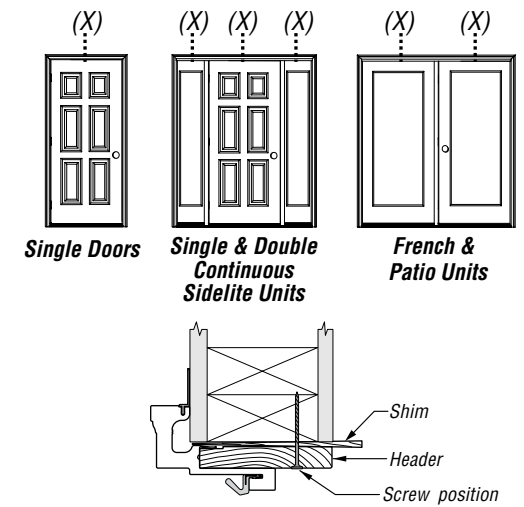

8 Caulking Sill

Caulk must be applied to the intersection of the aluminum sill extrusion and the jamb.

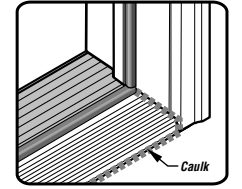

Seal front bottom edge of sill.

Caulk around the intersection of the mull and the door sill.

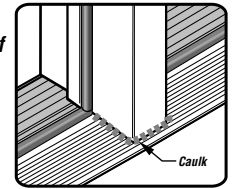

If a sill extender is installed, apply a bead of caulk where the extender meets the sill.

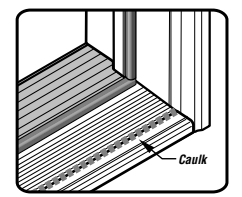

9 Astragal Positioning (French)

Close the passive door to verify that it is in the desired position.

Push bolt pins to contact header and sill, then mark positions for retainer holes.

Complete installation and positioning of astragal according to Endura's "Field Installation Instructions" provided with the French unit.

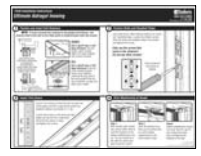

The strikes should be adjusted as far in the direction of door closure as possible to assure that the strikes pull the door up to the weatherstrip tightly.

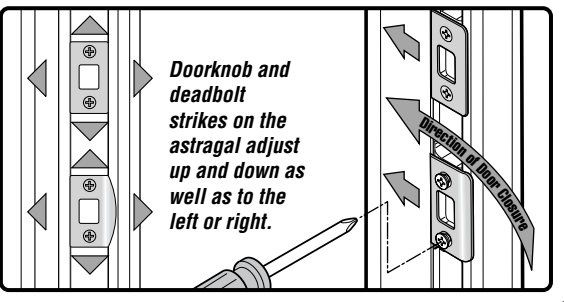

10 Apply Flashing Tape

Apply flashing tape around door unit as per manufacturer's instructions.

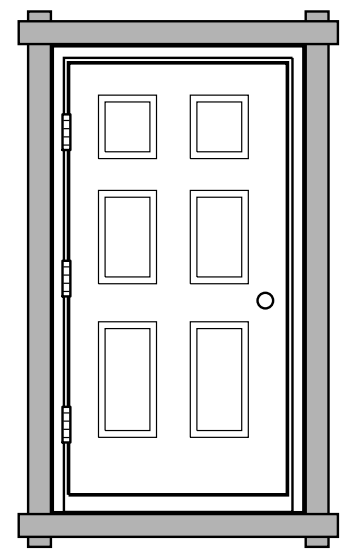

Simple Solution and "It's How Doors Work" are trademarks of Endura Products, Inc. All rights reserved.