

**Note:** Follow these instructions after the door unit has been fastened to the rough opening

## 1 Position and Install Bolt Retainers

**NOTE:** To ensure accurate hole locations for the astragal bolt retainers, first properly install corner pad on door hinge jambs to establish proper jamb side margins.

contact header approx.  
7/8" from jamb stop

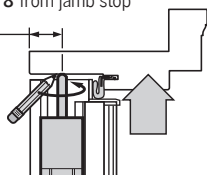

Close passive door until header weatherstrip is compressed. Push bolt pins to contact header and center of sill cap and mark for drilling retainer holes.

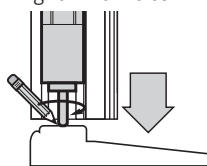

contact sill cap approx.  
7/8" from back of cap nosing

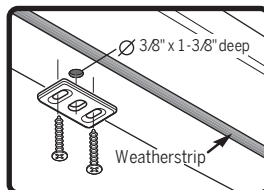

### HEADER:

Drill a  $\varnothing 3/8$ " hole (1-3/8" deep minimum) into the header where marked. Attach the Upper Retainer with screws provided.

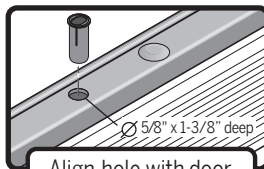

### SILL:

Drill a  $\varnothing 5/8$ " hole (1-3/8" deep minimum) in the sill at the marked location. Insert Lower Retainer, orienting the long side of the hole parallel to the sill cap (as shown) and tap into place with a mallet.

Align hole with door unit as shown

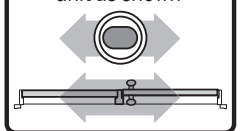

Inswing

**NOTE:** To insure accurate hole locations for the astragal bolt retainers, first properly install corner pad on door hinge jambs to establish proper jamb side margins.

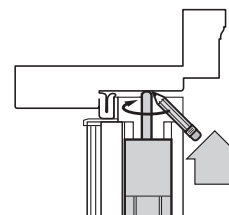

Close passive door until header weatherstrip is compressed. Push bolt pins to contact header and sill. Mark for drilling retainer holes.

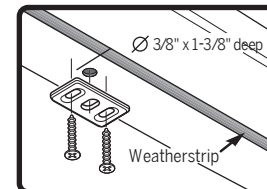
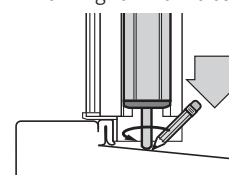

### HEADER:

Drill a  $\varnothing 3/8$ " hole (1-3/8" deep minimum) into the header where marked. Attach the Upper Retainer with screws provided.

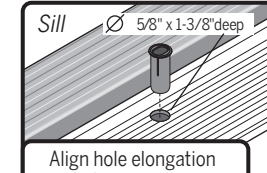

### SILL:

Drill a  $\varnothing 5/8$ " hole (1-3/8" deep minimum) in the sill at the marked location. Apply a bed of sealant to bottom of drilled hole. Insert Lower Retainer, orienting the long side of the hole parallel to the sill cap (as shown) and tap into place with a mallet.

Align hole elongation with door unit.

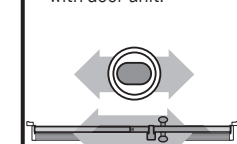

Outswing

## 2 Cut Weatherstrip at Header

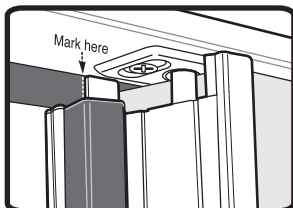

**Step 1:** With inactive door closed, use a sharp utility knife to mark the location on the header weatherstrip to be cut. The cut should be in line with the active door side edge of the trim cap fin.

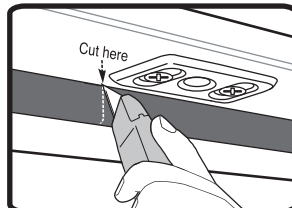

**Step 2:** Open the inactive door, then use the utility knife to cut the header weatherstrip flexible leg on the mark made in Step 1.

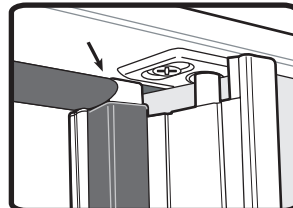

**Result:** Header weatherstrip should now clear the trim cap fin and contact the active door maintaining the integrity of the seal.